

Commercial Feeds in Kentucky

1961

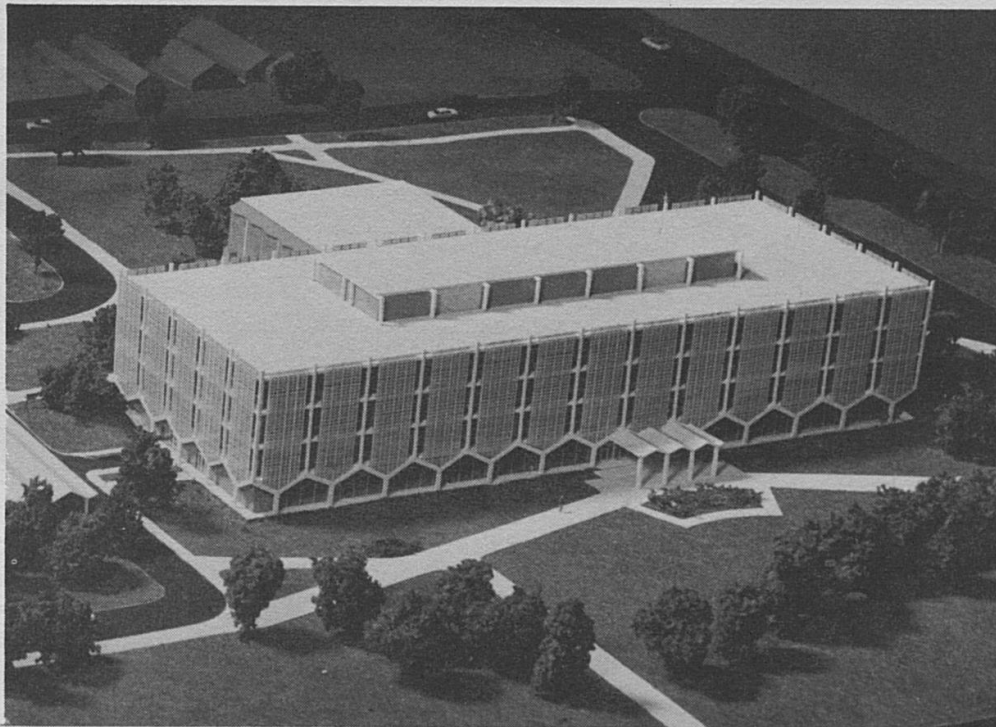

New Agricultural Science Center
to be constructed on Experiment Station Farm

Regulatory Bulletin 172

University of Kentucky
Agricultural Experiment Station
Feed & Fertilizer Department

Lexington

RECEIVED

JUN 4 '62

EXPERIMENT STATION
LIBRARY

FEED AND FERTILIZER DEPARTMENT
KENTUCKY AGRICULTURAL EXPERIMENT STATION

Bruce Poundstone, Head of Department
Robert Mathews, Asst. Adm. & Chief Inspector
Guy P. Zickefoose, Auditor-Inspector
**David M. Daugherty, Registration Inspector
W. J. Huffman, Registration Inspector

FIELD INSPECTION

Otis R. Wheeler
M. M. Davis

Neville Hulette

Noel J. Howard
W. M. Routt

LABORATORY

Harry R. Allen
Valva Midkiff
J. T. Adair
Paul R. Caudill

J. A. Shrader
Dewey H. Newman, Jr.
Clyde Bradway
John Ellis

Lelah Gault
Norma Holbrook
Robert N. Price
* *E. F. Asher

CONTENTS

	Page
Introduction	3
Estimated Tonnage of Sales by Class of Feed, Kentucky 1961.....	4
Companies on Reporting System, April 1, 1962	5
Recommendations for Registration and Preparation of Labels for Medicated feeds	8
Drug & Feed Additives	14
Urea	16
Weights per Bushel	17
Average Composition of the More Common Feedstuffs	18
Miscellaneous Samples Analyzed 1961	20
Table 1 - Report of Official Samples Analyzed 1961	21
Table 2 - Samples Classified as "Not Passed"	29

**Resigned in 1961

This report compiled and prepared by Robert Mathews and Bruce Poundstone.
Analytical data by the laboratory staff.

INTRODUCTION

This bulletin contains the results of inspection and analysis of commercial feeds sold in Kentucky during the calendar year of 1961 and other information helpful to those interested in this field.

During the year 1961, 576,920 tons of commercial feed were reported as distributed in the state of Kentucky. This was 3,732 tons less than was sold in 1960. Of this amount 20,215 tons was cattle feed, 98,302 dairy feed, 89,521 pig and hog feed, 162,301 poultry feed, 8,922 scratch feed, 7,863 turkey mashes, 28,757 corn products, 19,380 molasses, 17,815 soybean products and 35,529 wheat products. A complete report of tons of feed sold will be found on page 4.

During 1961, 3,316 official samples of feed were secured by inspectors and 2,629 or 79% of these passed with 687 or 21% not passing. During the year 1960, 84% of the samples taken passed and 16% did not pass.

This increase in samples "not passed" is in part at least due to the larger number of drugs now found in feed. In 1960, 565 drug determinations were made. 1,127 such determinations were made in 1961.

More medicated feeds are used each year. Farmers using medicated feeds should be very careful to feed according to the directions supplied on the label and no medicated feed should be fed to animals except those so designated.

On page 8, of this bulletin are listed recommendations for registration and preparation of labels for medicated feeds. Feed manufacturers making feeds containing a medicant should follow these. If more information is needed, manufacturers should contact firms supplying the drug or write to the Department of Feed and Fertilizer.

ESTIMATED TONNAGE OF SALES BY CLASS OF FEED
KENTUCKY, 1961

<u>Mixed Feed</u>	<u>Tons</u>
Calf Feed	5,184
Cattle Feed	20,215
Dairy Feed	98,302
Dog & Cat Feed	13,246
Horse & Mule Feed	12,529
Mineral Feed	7,319
Pig & Hog Feed	89,521
Poultry Mashs	162,301
Rabbit Feed	1,708
Scratch Feed	8,922
Sheep Feed	1,086
Stock Feed	1,835
Turkey Mashs	7,863
Miscellaneous Mixed Feed	<u>11,637</u>
TOTAL MIXED FEED	441,668
	<u>Tons</u>
<u>Straight Materials</u>	
Alfalfa Products	2,135
Animal Products	8,671
Barley Products	181
Brewers Products	2,640
Corn Products	28,757
Cottonseed Products	10,794
Distillers Products	4,925
Linseed & Flax Products	192
Molasses	19,380
Oat Products	1,606
Soybean Products	17,815
Wheat Products	35,529
Miscellaneous Products	<u>2,627</u>
TOTAL STRAIGHT MATERIAL	<u>135,252</u>
GRAND TOTAL	576,920

COMPANIES ON REPORTING SYSTEM, APRIL 1, 1962

Acme-Evans Co., Inc.
 Albers Milling Company
 All-In-One Feeds, Inc.
 Allied Food Distributors
 Allied Industries, Inc.
 Allied Mills, Inc.
 American Crystal Sugar Co.
 Anderson & Spilman
 Apex Feed & Supply (s)
 Archer-Daniel-Midland Co.
 Armour and Company
 Armour Creameries
 C. T. Ashley Company
 Aubrey Feed Mills, Inc.
 August Moldenhauer Mill
 Aylor & Meyer Company

Baber's Vis-Vita Sales, Inc.
 Bagdad Roller Mills
 Barry Carter Milling Co.
 Barton Distilling Co.
 Bates Farm Supply (b)
 The Baugh & Sons Co.
 Bay State Milling Co.
 The Beardstown Mills Co.
 Best Feeds & Farm Supplies, Inc.
 Big Four Feed Store (s)
 Big Sandy Wholesale Company
 L. A. Black
 Blatchford Calf Meal Co.
 Blenda Life, Inc.
 Bobb Brothers
 The Borden Company
 The Boswell Company
 Botkins Grain & Feed Co.
 Bradley & Baker
 Bremco Alfalfa Mills, Inc.
 Brennan Packing Co.
 The Brode' Corporation
 Brown-Forman Distillers Corp.
 The Buhler Mill & Elevator Co.
 Buhner & Company, Inc.
 The Buckeye Cellulose Corp.

Cadiz Milling Company
 The Carey Salt Co.
 Cargill, Incorporated
 Carson Food Company
 Cashman's Leghorn Farm
 Central Alfalfa, Inc.
 Central Soya Company
 Chelsea Milling Company
 Clark Milling Co.
 Cleveland Milling Co.
 Clinton Foods, Inc.
 Clinton Milling Co., Inc.
 Cocke and Company
 Colby Milling Co.
 H. C. Cole Milling Co.
 Colonial Stores, Inc.

Colorado Milling & Elevator Co.
 Columbian Hog & Cattle Powder Co.
 Columbus Canning Company
 Commander-Larabee Milling Co.
 Consolidated Flour Mills Co.
 Consolidated Products Co.
 Cooperative Mills, Inc.
 Corn Products Company
 Chas M. Cox Company
 Crestwood Farmers Supply Center
 Culton's Seed Cleaner

Dearborn Mills
 Decatur Cotton Oil Co.
 Decatur Elevator Co.
 Decatur Milling Co., Inc.
 Diamond Crystal Salt Co.
 Dixie Grain Co., Inc.
 Dixie Mills Company
 Dixie Portland Flour Co.
 Dixie Portland Flour Mills (Tenn.)
 Dixie Portland Flour Mills (Kan.)
 Dixie Treat Sales Co.
 Doane Feed Products Company
 Dyersburg Oil Mill Co.

The Early & Daniel Co.
 Eckhart Milling Company
 Elam Grain Company
 The F. L. Emmert Co.
 John W. Eshelman & Sons
 John Ewing Company
 Evans Industries, Inc.
 Evans Milling Co., Inc.
 Excelsior Milling Co.
 Eshelman Grain Co.
 Fabro, Inc.
 Farm Chef Feeds
 Farm Service, Inc.
 Farmers Elevators, Inc.
 Farmers Friend Mineral Co.
 Farmers Hay & Seed Co. (b)
 Farmers Service (b)
 Farmers Supply Co.
 Ferncliff Feed & Grain Co. (d)
 Finch Packing (d)
 Flambeau Milling Co.
 Fort Negley Mills
 Foster Canning Co.
 Frosty Morn Meats
 Henry Fruechtenicht Co.
 Fruen Milling Co.
 Fuhrer-Ford Milling Co.
 Funk Bros. Seed Co.

Garden Street Mill & Elevator
 Garrard Mills
 General Foods Corporation
 Corn Mill Division
 Gaines Division

(s) Small packages only, (b) Bulk sales only, (m) Molasses only, (d) Dog food only

General Mills, Inc.
 Goldenrod Oil Meal Sales Co.
 The Great Atlantic & Pacific Tea Co.
 The Great Western Sugar Co.
 Green County Milling Co. (b)
 Gwinn Brothers Co.

Hales & Hunter Company
 Peter Hand Foundation (s)
 Happy Valley Mills
 Harpeth Mills
 J. M. Harris & Co., Inc.
 Hartsville Milling Company
 Hartz Mountain Products Corp.
 Harvest Brand, Inc.
 Haydon Mill & Grain Co. (s)
 Hayward, Inc.
 Heckle Bros.
 Dr. Heinz Company
 Helmers & Berry Feed Co. (m)
 Hi-Life Packing Company
 Highland Products, Inc. (s)
 Hill Packing Company
 T. G. Hill & Co.
 Hoham Laboratories, Inc.
 Hollar & Mardis
 Holly Sugar Corporation
 Howdy Distributing Co.
 Hudson's Farm Service (b)
 The Hunter Milling Co.

Igleheart Bros. Div.
 Illinois Cereal Mills, Inc. (b)
 Illinois Soy Products Co.
 Independent Oil Mill, Inc.
 Inland Mills, Inc.
 International Milling Co.
 International Salt Co., Inc.
 The Ismert-Hincke Milling Co.

Jackson Co. Farm Bureau Coop. Ass'n.
 Jerry Ritchey & Co. (Dog)
 Jet Products, Inc.

K & K Mfg. Co.
 Kaler Milling Co.
 The Kansas Milling Co.
 Keco Milling Company
 Kellogg Company
 Spencer Kellogg & Sons, Inc.
 The Kennel Food Supply Co., Inc. (s)
 Kentucky By-Products Corp.
 Kentucky Chemical Industries, Inc.
 Keynes Brothers
 H. C. Knoke & Co.
 Kraft Foods

LaCross Milling Co., Inc.
 Lake County Oil Mills
 Lake States Yeast Corp.
 Land-O-Nan Warehouse (b)
 Edmond J. Lang

Lewisburg Roller Mills (b)
 Lexington Roller Mills, Inc.
 Life Guard Feeds
 Light Grain & Milling Co., Inc.
 Limestone Products Corp. of America
 Linden Mill (d)
 Lipscomb Farm Supply (b)
 Lose Bros.
 L. B. Lovitt & Co.

Magic Feed Mills, Inc.
 Marblehead Lime Co.
 Marco Mills, Inc.
 Marianna Sales Co.
 Marion Milling Co.
 Markin Feed Co.
 Martha White Flour Mills
 Martha White Flour Mills of W. Va.
 Martin Sales Co.
 Master Feed & Seed Co., Inc.
 Mavar Shrimp & Oyster Co. (Cat)
 Mayfield Milling Co., Inc.
 McKnight-Keaton Grocery
 McMillen Feed Mills
 Mennel Milling Co.
 Metcalfe Co. Farm Supply, Inc.
 O. W. Meyer Laboratories
 Middlesboro Milling Co. (s)
 Midland Flour Milling Co.
 Midsouth Milling Co.
 Midwest Alfalfa Blenders, Inc.
 Midwest Brewers Yeast Co.
 Midwest Feeds
 Milliken Sweet Feed Mill
 Mineral Products Co.
 Minute Maid Corp.
 Model Mills
 Mohawk Roller Mills
 Monroe Co. Farmers Service, Inc.
 Moore-Lowry Flour Mills, Inc.
 Moorman Manufacturing Co.
 The Mor-Milk Co.
 John Morrel & Co.
 Morristown Milling Co.
 Morton Salt Company
 Mowat, Wilson & Co.
 Mt. Sterling Hatchery (b)
 Murphy Products Co.
 Mutual Products Co. (s)
 Myers & Clark Milling Co., Inc.
 Myzon, Inc.

H. Nagel & Son
 Nashville Cotton Oil Mill Corp.
 National Alfalfa Dehyd. & Milling Co.
 National Biscuit Co.
 National Molasses Co.
 National Oats Co.
 National Remedy Products Co., Inc.
 National Vitamin Products Co.
 Nebraska Consolidated Mills Co.
 Neumond, Inc.

The North Amer. Trading & Import Co.
Northern Ohio Sugar Co.
Chas. Nunn & Sons Milling Co.
Nutrena Mills, Inc.

Oelwein Chemical Co., Inc.
Ohio Valley Soybean Cooperative
Orleans Candy Company
Orleans Canning Co.
Owensboro Grain Co.

Pacific Molasses Co.
Packers By-Products Co.
Pan American Mills (s)
Park & Tilford Distillers Corp.
Phillip R. Park, Inc.
Pedrick Laboratories
Pendleton County Mills
Penick & Ford, Ltd., Inc.
Perfection Foods Co.
Pillsbury Company
Pittsburgh Plate Glass Co.
Planters Manufacturing Co.
Provico Feeds & Concentrates
Publicker Chemical Corp.
Publicker Industries, Inc.

The Quaker Oats Company
Quinnmenhaden Fisheries

Ralston Purina Company
Lloyd Reiterman
Riteway Milling Co.
Riverside Molasses Co.
Robinson Milling Co. (m)
Rome Oil Mill
G. P. Rose & Co., Inc.
The Ross Milling Co.
Russell Grain Company
Russell-Miller Milling Co.
Ryde & Company

S & O Products, Inc.
Sandusky Brothers
Salyersville Wholesale Co.
Charles W. Schenk & Sons (s)
Schenley Distillers, Inc.
John Schlemmer
Scientific Milling Co.
The Scott County Milling Co.
Seaboard Allied Milling Co.
Joseph E. Seagram & Sons, Inc.
Security Food Company
Security Mills, Inc.
Shellabargers, Inc.
The Sherwin-Williams Co.
Sikeston Cotton Oil Mill
Simmons Milk Products, Inc.
The W. J. Small Co. Div.
J. Allen Smith
Smith Packing Company
Southern Canning Sales, Inc.

The Southern Cotton Oil Co. (Ala.)
The Southern Cotton Oil Co. (Tenn.)
Southern Products Co., Inc.
Southern States Bardstown Coop.
Southern States Bowling Green Coop.
Southern States Boyle Coop.
Southern States Campbellsville Coop.
Southern States Fulton Coop.
Southern States Glasgow Coop.
Southern States Hardin Coop.
Southern States Henderson Coop.
Southern States Hopkinsville Coop.
Southern States LaGrange Coop.
Southern States Lebanon Coop.
Southern States Leitchfield Coop.
Southern States London Coop.
Southern States Somerset Coop.
Specialty Food Company
Specifide, Inc.
Spem-Well Feed Company
A. E. Staley Manufacturing Co.
Standard Brands, Inc.
Standard Feed Milling Co., Inc.
Standard Products Co., Inc.
F. W. Stock & Sons, Inc.
Suni-Citrus Products Co.
Sunshine Feed Mill
Sunshine Feed Mill, Inc.
Sunshine Molasses Co.
Supreme Mills
Sweet Feed, Inc.
Swift & Company (Chicago)
Swift & Company (Memphis)
Swift & Company - Oil Mill
Swift & Company - Pard Food Dept.

Teater-Cassity-Wade (m)
The Topeka Flour Mills Corp.
Trenton Cotton Oil Company
Tri-State Molasses Company

Union Sales Corporation
United Salt Corporation
Usen Canning Company

Valier & Spies Milling Co.
Varner Milling Company
Vets Div. Perk Foods Co.
Virginia-Carolina Chemical Corp.
Vita Fresh Dog Food Corp.
Vitamineral Products Co.
VyLactos Laboratories, Inc.

W & W Hamstery
Walters & Thompson (m)
Weisenberger Sanitary Flour Mills
Western Condensing Company
Western Grain Company
Whitewater Flour Mills Co.
William Davies Co., Inc.
Williamstown Roller Mills (b)
Woolcott Mills, Inc.

Yieldmor Feeds, Inc.

RECOMMENDATIONS FOR REGISTRATION AND PREPARATION
OF LABELS FOR MEDICATED FEEDS

A Medicated Feed is any feed which contains drug ingredients (a) intended or represented for the cure, mitigation, treatment or prevention of disease of animals other than man or (b) intended to affect the structure of any function of the body of animals other than man. Excepted are feeds which supply antibiotics to the animal at a non-therapeutic level.

A. Information Required on the Label. In addition to the information required for non-medicated feeds, medicated feeds are required to carry the following information in their labeling: (a) the purpose of the medication; (b) directions for use of the feed; (c) the names and amounts of all active drug ingredients; (d) a warning or caution statement for a withdrawal period when required for the particular drug contained in the feed and (e) warnings against misuse. It is suggested that the label include this information in the following form:

1. Net Weight.
2. Brand name or trade name.
3. Product name (may include brand name and, for Types 1 and 2, the word "Medicated").
4. Purpose (statement of the purpose of the medication and reference to directions for use).
5. Active drug ingredients (list of common names, not trade names, and percentage present, for each drug. Antibiotics are to be expressed in grams per pound or grams per ton).
6. Guaranteed analysis of the feed.
7. Feed Ingredients (common name of each).
8. Name and address of manufacturer or registrant.
9. Detailed feeding directions (to be displayed prominently on either front or reverse side of the label). A check list follows:
 - a. Purpose (if necessary to clarify or amplify the above statement).
 - b. When to feed (specific period necessary for effective use).
 - c. How to feed, or mix for feeding (feeding method to be followed, i. e., free choice, sole ration, intermittent feeding, etc.; mixing directions for premixes, etc., should give proper level of medication for purpose intended).
 - d. Precautions (statement of precautions where misuse of the product may be injurious to animal or man).
 - e. Warning statement (a withdrawal period may be required for safety. With a mixture of drugs, use the longest period). See example below.
 - f. Other feeds (reference may be made to other feeds which have a part in a feeding program for the animal).

Suggested Warning and Caution Statements

1. Acetylaminothiazole for Poultry.
Warning--Discontinue use at least 1 week before slaughtering birds for food to permit elimination of the drug from food.
2. Aminonitrothiazole (2-Amino-5-Nitrothiazole) for Poultry.
Warning--Discontinue use at least 1 week before slaughtering birds for food to permit elimination of the drug from the food.
3. Amprolium for Poultry.
Warning--Do not feed to laying birds in production.
4. Anthelmintics Containing Cadmium Oxide and Cadmium Anthranilate.
Caution--Consult veterinarian before using in severely debilitated animals.
Warning--Treated hogs must not be slaughtered for food for at least 30 days following treatment to permit elimination of cadmium residues from food.
5. Arsenicals (Organic, for Poultry and Swine).
Warning--Do not administer to laying hens. Discontinue use at least 5 days before slaughtering animals for food consumption to permit elimination of the drug from the food.
The above warning concerning laying hens is not required on arsenic preparations that have been shown to leave no residue in eggs (3-nitro-4-hydroxyphenyl arsonic acid, arsanilic acid and arsenosobenzene).

6. Dienestrol Diacetate for Poultry.
Warning--Discontinue use at least 48 hours before slaughtering birds for food to permit elimination of the drug from the food. Do not feed to laying hens or breeding stock.
7. Diethylstilbestrol in Animal Feed.
Warning--Discontinue use at least 48 hours before slaughtering animals for food to permit elimination of the drug from the food.
8. Glycarbylamide for Poultry.
Warning--Do not feed to laying hens in production. Discontinue use at least 4 days before slaughtering birds for food to permit elimination of the drug from the food.
9. Nicarbazin for Poultry.
Warning--Do not feed to laying hens in production. Discontinue use at least 4 days before slaughtering birds for food to permit elimination of the drug from the food.
10. Nithiazide for Poultry.
Warning--Do not feed to laying hens in production. Discontinue use at least 24 hours before slaughtering birds for food to permit elimination of the drug from the food.
11. Novobiocin for Poultry.
Warning--Discontinue use 3 days before slaughtering birds for food to permit elimination of the drug from the food.
12. Promazine Hydrochloride for Cattle and Horses.
Warning--Do not feed to lactating dairy animals. Discontinue use 72 hours before slaughtering animals for food to permit elimination of the drug from the food.
13. Ronnel for Beef Cattle
Warning--When fed at 0.275 per cent, feed continuously for 14 days. When fed at 0.6 per cent, feed continuously for 7 days. Do not feed to dairy cattle. Discontinue use 60 days before slaughtering animals for food to permit elimination of the drug from the food.

Required Warning Statements For Drugs Used With Certified
Antibiotics

- 3-Nitro-4-Hydroxyphenyl Arsonic Acid (3-Nitro-4-Hydroxyphenylarsonic Acid) for Poultry and Swine.
Warning--Discontinue use 5 days before the treated animals are slaughtered for human consumption.
- Chlortetracycline for Leptospirosis of Swine.
The following warning is required on preparations containing, per ton of feed, 400 grams of chlortetracycline:
Warning--Discontinue use 10 days before the treated animals are slaughtered for human consumption.
- Dienestrol Diacetate for Poultry.
Warning--Do not use in laying hens. Discontinue use 24 hours before the treated birds are slaughtered for human consumption.
- Diethylstilbestrol for Sheep.
Warning--Discontinue use 48 hours before the treated animals are slaughtered for human consumption.
- 3,5-Dinitrobenzamide for Poultry.
Warning--Do not feed to laying hens. Discontinue use 48 hours before the treated animals are slaughtered for human consumption.
- Glycarbylamide (4,5-Imidazole-Dicarboxamide) for Chickens.
Warning--Do not feed to laying hens. Discontinue use 4 days before the treated chickens are slaughtered for human consumption.
- Hygromycin B for Swine.
Warning--Discontinue use 48 hours before the treated swine are slaughtered for human consumption.
- Nithiazide (1-ethyl-3(5-Nitro-2-Thiazolyl) Urea) for Poultry.
Warning--Do not feed to laying hens. Discontinue use 24 hours before treated birds are slaughtered for human consumption.

Nystatin for Turkeys.

Warning--If used in laying hens, eggs are to be used for hatching purposes only.

NOTE--Consult Federal Register for published food additive regulations.

B. Types of Labels. Labels for medicated complete feeds generally fall into four different types, as follows (sample formats are shown on pages 12&13):

Type 1 is for a feed which contains drug (s) for growth promotion and/or disease prevention, and which is to be fed continuously for an indefinite period. The product name is followed by the word "medicated" in letters at least half as tall as those of the product name. This type of label can be used for any drug-containing feed not included among the other types. Exempted from medicated labeling are feeds which contain non-therapeutic levels of antibiotics (those with less than 50 grams per ton usually qualify), since these are not classed as medicated feeds. Salt to which an antibiotic is added for control of bloat is to carry a medicated (Type 1) label, except when the brand name includes specific disease control terms such as "anti-bloat".

Type 2 is for a feed which contains drug (s) at the treatment level, to be fed as the sole ration for a limited period of time. The word "medicated" appears in the forepart of the product name, in letters of the same size as remainder of product name.

Type 3 is for a feed which contains hormone (s) or hormone-like substances (e. g., diethylstilbestrol). For feeds which contain a hormone plus other drugs, only the hormone is to appear in the product name. The product name "Stilbestrol Mixture" or "Stilbestrol Mixture in Doe's Feed" may be followed by the words, "Medicated for the prevention of-----" (or other statement of purpose) and then followed by the list and amounts of active drug ingredients. Feeds to which iodinated casein is added for stimulating milk production are to carry a hormone-type label (Type 3)

Type 4 is for a feed which contains drug (s) at the treatment level for a specific disease or condition. It differs from Type 2 only in that the product name indicates the purpose of the drug and the word "medicated" thus need not be a part of the product name (e. g., "Pig Wormer"). In labeling feeds which contain anthelmintics, use Type 1 label if feeding is to be continuous, Type 2 if feeding is to be intermittent, and Type 4 in either case if the product name includes the word "wormer"

C. Supplements or Premixes which contain drugs and which are to be diluted by mixing with other feeds before use are also covered by these four types of labels. The type of label to be used in each case will depend upon the purpose of the drug and directions for use of the finished feed after such dilution. If the resulting feed when diluted according to directions will contain non-therapeutic levels and no therapeutic claims are made Type 1 label will be used, except for feeds containing only antibiotics. If the directions given are such that Type 2 as well as Type 1 can apply, then the Type 2 label must be used. Mixing or feeding directions for one or more uses should be provided on all containers, for wholesale as well as retail distribution (since all wholesale products often get into retail channels). The following statement should also be added where applicable: "For other uses, see instructions provided by your supplier."

For supplements which contain only antibiotics, the directions for use determine whether medicated labeling is required. Suppose the supplement contains 400 grams of antibiotic per ton. If directions include dilution to 50 or more grams per ton before feeding, therapeutic claims should be made and the antibiotic (s) guaranteed under "Active Drug Ingredients." However, if directions are to dilute 20 grams per ton before feeding and no therapeutic claims are made, the supplement is not regarded as a medicated feed.

D. Where to List Antibiotics on a Feed Label.

(a) If therapeutic claims for the antibiotic are made in the statement of purpose, then the antibiotic should be listed among the "Active Drug Ingredients" irrespective of the amount present (even when less than 50 grams per ton).

(b) If the purpose of the antibiotic in the feed is non-therapeutic (i. e., only growth and/or feed efficiency), the antibiotic is not to be listed as an active drug ingredient but the common name of each antibiotic present is to be stated either under "Guaranteed Analysis" or in the list of feed ingredients. The name and amount of each antibiotic should appear under "Guaranteed Analysis" on the label of a premix or supplement which is to be diluted, and such a declaration on the label of a finished feed is also encouraged but not required. The term "antibiotic feed supplement" is no longer acceptable in the list of feed ingredients. The term "Vitamin B12 and antibiotic feed supplement" also will not be acceptable; the appropriate term defined under Fermentation Products should be used.

E. Submitting Copy for Registration. It is suggested that typed copy of proposed labeling for medicated feeds be submitted to State and Federal officials for comment before the copy is sent to the printer. This may save the cost of printing unacceptable labels.

Because drugs in feeds may result in tissue residues of the animals which consume the medicated feed, the assay of animal feeds is highly important along with warning statements indicating specific withdrawal times of medicated feeds. No drug or combination of drugs in feeds for animals should be submitted for registration unless a collaboratively tested method for the analysis of the drug in feeds of the type to be used is also submitted.

Code designations of numbers and/or letters may be used in the product name on the label as an aid to identification (see Type 1 label below), but printing in the margin (side-bar labeling) is discouraged. Two-digit numbers should in no way mislead or confuse the customer. Code designations should not include letters which represent abbreviations of drugs, vitamins or other components of feed since this may emphasize certain ingredients more than others.

SAMPLE LABELS

An example of each of the four types of labels is shown below. The drugs listed on these labels were selected only for illustrative purposes and it is not intended to imply that they are preferred over other drugs which may be used for the same purpose.

**BLUE BIRD
TURKEY GROWER (EI)
Medicated**

A preventive against outbreaks of blackhead in turkey flocks when fed according to directions on this label.

Active Drug Ingredient (s)

2-Acetylamino-5-nitrothiazole0.015%

Guaranteed Analysis

INGREDIENTS

Manufactured by
BLUE BIRD FEED MILLS
MILLVILLE, KENTUCKY
100 LBS. NET WEIGHT

Type 1 Label

**BLUE BIRD
MEDICATED HOG
RATION (PDQ)**

For the treatment of infectious enteritis in swine when fed as directed on this label.

Active Drug Ingredients

Streptomycin...0.075 grams per lb. (as streptomycin sulfate)
Penicillin0.025 grams procaine penicillin per pound equivalent to 0.0156 grams penicillin G (Master Standard)
Arsanillic Acid0.01%

Guaranteed Analysis

INGREDIENTS

Manufactured by
BLUE BIRD FEED MILLS
MILLVILLE, KENTUCKY
100 LBS. NET WEIGHT

Type 2 Label

BLUE BIRD
0.0011% DIETHYLSTIL-
BESTROL MIXTURE
FOR FATTENING BEEF CATTLE

Feed at the rate of 2 lbs. per animal per day. Each pound contains 5 milligrams diethylstilbestrol.

CAUTION: Use Only as Directed

Active Drug Ingredient:
 Diethylstilbestrol -----0.0011%

Incorporated in
BLUE BIRD STEER FEED

Guaranteed Analysis

INGREDIENTS

Manufactured by
BLUE BIRD FEED MILLS
 MILLVILLE, KENTUCKY
 100 LBS. NET WEIGHT

Type 3 Label

BLUE BIRD
HOG WORMER

For the Removal of Large Roundworms (*Ascaris Lumbricoides*). Follow directions on other side of tag.

Active Drug Ingredient:
 Cadmium Oxide -----0.015%

Guaranteed Analysis

INGREDIENTS

Manufactured by
BLUE BIRD FEED MILLS
 MILLVILLE, KENTUCKY
 100 LBS. NET WEIGHT

Type 4 Label

DRUGS AND FEED ADDITIVES
Tentative

T-7. Certifiable antibiotics, a special class of drugs, are those antibiotics listed in Section 507 (a) of the Federal Food, Drug, and Cosmetic Act namely

penicillin
streptomycin
chlortetracycline
chloramphenicol
bacitracin

and any derivative thereof. Examples of derivatives would be dihydrostreptomycin, zinc bacitracin, and tetracycline. When drugs subject to certification are added to animal feed, data must be available to show the safety and therapeutic efficacy for the claims made in the labeling. This is the significant difference between certifiable products and new drugs. When new drugs are included in a product containing a certifiable antibiotic, the claims for therapeutic efficacy must be established for the combination, and an Antibiotic Form 10 must be filed with the Food and Drug Administration before the product may be legally marketed in interstate commerce. The Antibiotic Form 10 is for all intents and purposes a new drug application with the additional requirements for the establishment of therapeutic efficacy for the product.

T-8. New Drugs are those drugs which the safety, because of short time in use, has not been completely established. Before feeds containing new drugs can be marketed in interstate commerce, there must be on file with the Food and Drug Administration an effective new drug application for the particular feed. New drug applications are made effective solely on the basis of safety. Therapeutic efficacy is not taken into consideration. Antibiotics which are not subject to certification are handled as new drugs under the Federal Food, Drug, and Cosmetic Act. The following are new drugs as of October 1961:

amprolium
arsenosobenzene
bithionol and methiotriazamine
diethylcarbamazine, dienestrol diacetate
diethylstilbestrol
enzymes (except pepsin)
hygromycin B
nicarbazin
2-acetyl-amino-5-nitrothiazole
2,4-diamino-5 (p-chlorophenyl) 6-ethylpyrimidine
3,5 dinitrobenzamide
glycarbylamide
hydroxazine hydrochloride
nithiazide
novobiocin
nystatin
oleandomycin
promazine hydrochloride
p-ureidobenzeneearsonic acid
reserpine
ronnel
tylosin
zoalene

T-9. Not New Drugs. Certain drugs cease to be classified as new drugs when in the opinion of experts qualified to judge the safety of new drugs, sufficient experience has been gained in their use to warrant their classification as not new drugs. These and other substances may be drugs, or even new drugs, under specific conditions of use and representation. The following are not new drugs:

acetyl (p-nitrophenyl) sulfanilamide
amino nitrothiazole
arsanilic acid
aterramin
cadmium anthranilate
cadmium oxide
di-N-butyltin dilaurate

2,2¹dihydroxy-5,5¹dichlorodiaphenyl-methane
 dinitrophenylsulfonylethylenediamine
 dried rumen bacteria
 dynafac
 erythromycin thiocyanate
 furazolidone
 iodinated casein
 menadione sodium bisulfite
 enomycin
 nicotine
 3-nitro-4 hydroxyphenyl arsonic acid
 nitrofurazone
 nitrophenide
 4-nitrophenyl-arsonic acid
 oxytetracycline
 para aminobenzoic acid
 pepsin
 phenothiazine
 piperazine
 piperazine dihydrochloride & monohydrochloride
 piperazine hexahydrate
 piperazine phosphate monohydrate
 piperazine sulfate
 sodium arsanilate
 sodium fluoride
 sodium or potassium salt of para aminobenzoic acid
 sodium propionate
 sulfaquinoxaline

T-10. Feed or food additive refers to any substance which becomes a component of or affects the characteristics of a feed or food if such substance is not generally recognized among experts qualified by scientific training and experience to evaluate its safety, as having been adequately shown through scientific procedures to be safe under the conditions of its intended use. Excepted are substances having "prior sanction" and pesticide chemicals under certain conditions. (See Public Law 85-929 for details.)

T-11. Antibiotic guarantees on the label. In terms of the amount of antibiotic present, equivalents and standards are as follows:

Penicillin: The term, penicillin, refers to sodium penicillin G (master standard) which is equivalent to 1.667 gram procaine penicillin.

Streptomycin: One gram is equal to 1.0 gram of streptomycin base.

Chlortetracycline: The term, chlortetracycline, may be used as an abbreviation for chlortetracycline hydrochloride, which is the standard.

Bacitracin: Zinc bacitracin, manganese bacitracin, bacitracin methylene disalicylate are expressed in terms of bacitracin activity which they contain. One gram of activity is equal to 1.0 grams of bacitracin master standard (42,000 units).

Oxytetracycline: One gram is equal to 1.0 grams of oxytetracycline base.

Novobiocin: One gram is equal to 1.0 grams of novobiocin acid.

Nystatin: One gram is equal to 2,800,000 units.

Oleandomycin: One gram is equal to 1.0 gram of oleandomycin base.

Tylosin: One gram is equal to 1.0 gram of tylosin base.

Hygromycin B: One gram is equal to 1,000,000 units of hygromycin activity.

Erythromycin: One gram of erythromycin base is equal to 1.08 gram of erythromycin thiocyanate.

UREA

The following information may be of some help to manufacturers and feeders using urea.

Urea is a white crystalline powder made by combining ammonia and carbon dioxide under pressure in equipment that will withstand high temperature.

Urea contains 46.5% nitrogen, which is equivalent to 291% protein. The commercial product "262" Feed Compound, is urea which has been diluted with other materials to prevent caking, and contains 42% nitrogen which is equivalent to 262% protein. The addition of 1 percent of this material to a dairy feed is equivalent to adding 2.62% protein. Besides urea's protein equivalent value, one must also consider its lack of energy value as compared to the common high protein feeds. An example of this, if the nitrogen in urea is used as efficiently as the nitrogen in high protein feeds, it will require approximately 14 pounds of urea, plus 100 pounds of grain to replace 100 pounds of soybean oilmeal.

Urea, when used as an ingredient in feeds sold in Kentucky is shown in the guaranteed analysis as follows: Crude Protein _____%. This includes not more than _____% equivalent crude protein from non-protein nitrogen. Crude Fat _____%. Crude Fiber _____%. One percent of "262 Feed Compound" would be 2.62% equivalent protein from non-protein nitrogen. Urea should be shown as an ingredient under "Ingredients".

Cattle, sheep, and goats are able to convert urea to a usable form through the action of micro-organisms in the rumen. The organisms convert the nitrogen of urea to protein in their cell bodies which are in turn digested by the animal.

Horses, swine, dogs, and other single-stomach animals are unable to utilize urea.

The Association of American Feed Control Officials has a regulation to the effect that urea be used in such limited quantities as to insure the total amount present shall not exceed 3 percent of the (grain) ration or 1/3 of the total protein. If a feed contains more than 3 percent of urea, the label shall bear a statement of proper usage and the following in type of such conspicuousness as to render it likely to be read and understood by ordinary individuals under customary conditions of purchase and use.

WARNING: This feed should be used only in accordance with directions furnished on the label.

WEIGHTS PER BUSHEL

Feeders and Feed Manufacturers often need to know the legal weight requirements for grain and seeds when sold for feeding and other purposes. The following is quoted from the Kentucky Revised Statutes in this connection.

363.040 (4821) Bushel, what weight constitutes. The following weights constitute a bushel of the article named:

- (1) Barley, forty-seven pounds.
- (2) Bluegrass seed, fourteen pounds.
- (3) Bottom onion sets, thirty-six pounds
- (4) Bran, twenty pounds.
- (5) Buckwheat, fifty-six pounds.
- (6) Castor beans, forty-five pounds.
- (7) Clover seed, sixty pounds.
- (8) Coal, seventy-six pounds.
- (9) Corn in the ear, seventy pounds, from November 1 to December 31 inclusive, and sixty-eight pounds at all other times of the year.
- (10) Corn meal, fifty pounds.
- (11) Corn, shelled, fifty-six pounds.
- (12) Dried apples, twenty-four pounds.
- (13) Dried peaches, thirty-nine pounds.
- (14) Ear corn in the shuck, seventy-five pounds.
- (15) English bluegrass seed, fourteen pounds.
- (16) Fine salt, fifty-five pounds.
- (17) Flax seed, fifty-six pounds.
- (18) Ground peas, twenty-four pounds.
- (19) Hemp seed, forty-four pounds.
- (20) Hungarian grass seed, fifty pounds.
- (21) Irish potatoes, sixty pounds.
- (22) Millet seed, fifty pounds.
- (23) Oats, shelled, thirty-two pounds.
- (24) Onions, fifty-seven pounds.
- (25) Orchard grass seed, fourteen pounds.
- (26) Peas, sixty pounds.
- (27) Plastering hair, eight pounds.
- (28) Rye, fifty-six pounds.
- (29) Salt, fifty pounds.
- (30) Sweet potatoes, fifty-five pounds.
- (31) Timothy seed, forty-five pounds.
- (32) Turnips, sixty pounds.
- (33) Unslaked lime, thirty-five pounds.
- (34) Wheat, sixty pounds.
- (35) White beans, sixty pounds.

AVERAGE COMPOSITION OF THE MORE COMMON FEEDSTUFFS

Feedstuff	Protein	Fats	Carbohydrates		Water	Ash
			Fiber	N. F. Extract		
Alfalfa Leaf Meal	21.0	2.8	16.0	40.5	7.7	12.0
Alfalfa Meal	14.0	2.0	30.0	36.0	9.0	9.0
Barley	12.0	2.0	5.4	67.3	10.6	2.7
Barley Feed	13.5	3.5	8.7	60.9	9.3	4.9
Beet Pulp, Dried	9.2	0.5	19.8	47.2	9.9	3.4
Blood, Dried	84.5	1.1	1.0	0.7	8.2	4.5
Bone Meal, Raw	26.0	5.0	1.0	2.5	6.4	59.1
Bone Meal, Steamed	7.5	1.2	1.5	3.2	5.7	81.3
Brewers Dried Grains	25.0	6.4	16.0	41.0	7.7	3.9
Buckwheat	10.8	2.5	10.5	62.3	12.0	1.9
Buttermilk, Dried	33.0	6.0	0.3	43.1	7.6	10.0
Buttermilk, Semi-Solid	13.4	3.0	0.0	15.9	65.0	2.7
Citrus Meal	5.9	3.1	11.5	62.7	9.9	6.9
Coconut Oil Meal	20.5	8.0	10.0	45.0	9.5	6.5
Corn	8.0	3.9	2.0	69.9	15.0	1.2
Corn Bran	9.7	7.3	9.2	62.0	9.4	2.4
Corn and Cob Meal	7.0	3.5	8.0	66.1	14.1	1.5
Crushed Ear Corn & Shucks	7.0	3.0	10.6	69.2	11.0	1.8
Corn Chop	8.0	3.5	2.0	71.0	14.0	1.5
Corn Feed Meal	8.0	4.5	3.0	71.0	11.4	2.0
Corn Germ Meal	21.0	9.0	9.0	50.7	7.0	3.3
Corn Gluten Feed	25.5	2.7	7.6	48.8	9.1	6.3
Corn Gluten Meal	43.1	2.0	4.0	39.8	8.6	2.5
Cottonseed Meal	41.5	6.3	10.4	28.1	7.2	6.5
Cottonseed Meal Solvent	41.1	2.1	11.0	31.1	9.2	6.8
Cottonseed Feed	34.6	6.3	14.1	31.5	7.6	5.9
Distillers Dried Grains, Corn	26.1	8.8	12.8	44.2	7.1	2.5
Distillers Dried Grains, Rye	24.4	5.6	11.5	48.3	6.1	22.4
Distillers Dried Solubles	28.5	9.6	4.4	42.5	7.0	7.4
Fish Meal	60.9	6.8	0.9	5.0	7.1	17.6
Flaxseed	24.0	35.9	6.3	24.0	9.2	4.3
Flaxseed Screenings Oil Feed	25.0	7.1	11.7	40.3	8.1	7.8
Hominy Feed	11.2	6.9	5.2	64.2	9.6	2.9
Lespedeza Seed	36.6	7.6	9.6	32.8	8.3	5.1
Linseed Meal	35.4	5.8	8.2	36.0	9.0	5.6
Linseed Meal Solvent	36.6	1.0	9.3	38.3	9.6	5.6
Malt Sprouts	26.8	1.3	14.2	44.3	7.4	6.0
Meat Scraps 55%	55.8	9.3	2.1	1.3	6.1	25.4
Meat & Bone Scraps, 50%	51.0	10.1	2.1	1.6	6.1	29.1
Molasses, Cane	3.0	0.0	0.0	61.7	25.7	6.1
Molasses, Beet	7.8	0.0	0.0	62.1	22.0	7.0
Oats	12.0	4.6	11.0	58.6	10.4	3.4
Oat Kernels	16.0	6.4	1.6	66.0	8.0	2.0
Oat Middlings	15.9	5.2	3.3	64.6	8.6	2.4
Peanut Kernels	30.4	47.7	2.5	11.7	5.4	2.3
Peanut Meal	43.5	7.6	13.3	23.4	7.0	5.2
Peanut Meal, Solvent	51.5	1.4	5.7	27.2	8.4	5.8
Peanut Skins	15.9	22.4	10.6	42.2	6.2	2.7
Rice Bran	12.5	12.5	12.5	44.0	9.0	9.5
Rye	11.8	1.8	1.8	73.2	9.4	2.0
Rye Middlings	16.6	3.4	5.2	61.2	9.8	3.8
Skimmed Milk, Dried	34.0	1.0	0.0	51.0	6.0	8.0
Sorghum Grains	9.5	3.4	2.0	72.2	12.0	1.9
Soybean (Seed)	36.5	17.5	4.3	26.5	9.9	5.3
Soybean Meal	44.3	5.3	5.7	29.6	9.1	6.0
Soybean Meal, Solvent	46.1	1.0	5.9	31.8	9.4	5.8

Average Composition of the More Common Feedstuffs, Continued

Feedstuff	Protein	Fats	Carbohydrates		Water	Ash
			Fiber	N. F. Extract		
Tankage, 60%	60.6	8.5	2.0	1.8	6.9	20.2
Tankage with Bone 50%	51.3	11.5	2.3	2.3	6.2	26.1
Wheat	10.5	1.7	2.8	72.9	10.2	1.9
Wheat Bran	14.0	3.5	9.5	56.9	10.1	6.0
Wheat Mill Run	13.5	3.5	7.5	60.2	10.1	5.2
Wheat Middlings	15.0	3.5	7.0	58.7	10.3	5.4
Wheat Shorts	15.0	3.5	6.0	60.6	10.5	4.4
Wheat Red Dog	16.0	3.5	3.0	66.4	8.5	2.6
Wheat Flour, Patent	10.9	1.3	0.4	74.7	12.3	0.5
Wheat Germ Meal	27.8	9.2	3.3	44.4	8.9	4.5
Grain Screenings (From Wheat)	10.5	1.7	2.8	70.8	9.6	4.6
Whey, Dried	12.2	0.8	0.2	70.4	6.5	9.9
Yeast Brewers, Dried	44.9	0.7	2.7	38.8	6.2	6.9
Yeast, Irradiated, Dried	48.7	1.1	5.5	32.2	6.4	6.4

ROUGHAGES

Alfalfa Hay	14.5	2.3	29.7	36.3	8.6	8.6
Blue Grass Hay	8.2	2.5	29.8	42.5	10.5	6.5
Clover Hay, White	14.4	2.4	22.5	40.9	12.0	7.8
Clover Hay, Red	11.8	2.6	27.3	40.1	11.8	6.4
Corn Stover, without ear	5.9	1.6	30.8	46.5	9.4	5.8
Corn Stover, with ear	7.8	2.2	27.1	47.6	8.9	6.4
Cowpea Hay	18.6	2.6	22.5	35.1	9.9	11.3
Fescue Hay	7.0	1.9	30.3	43.2	11.8	6.8
Lespedeza Hay	13.5	2.5	28.0	40.1	10.5	5.4
Soybean Hay	15.5	2.8	26.5	38.7	9.2	7.3
Timothy Hay	6.2	2.5	29.8	45.0	11.6	4.9

FILLERS

Alfalfa Stem Meal	11.5	1.3	36.3	34.8	9.0	7.1
Corn Cob	2.3	0.4	32.1	54.0	9.6	1.6
Corn Husk or Shuck	3.4	0.9	28.2	49.6	15.0	2.9
Cottonseed Hulls	3.9	1.0	45.5	37.2	9.7	2.7
Flax Plant By-Products	6.4	2.1	44.4	33.1	8.1	5.9
Oat Mill By-Product	5.6	1.8	27.9	50.8	7.6	6.3
Oat Hull Feed	3.5	1.5	32.5	49.3	7.6	5.6
Oat Hulls	3.0	1.0	35.0	47.7	6.8	6.5
Screenings*						
Chaff and dust**						

*Varies in quality from fair.

**Varies in quality from poor to worthless and even dangerous.

Miscellaneous Samples Analyzed in 1947-61

Feedstuff	Protein	Fat	Fiber
Activated Sewer Sludge	29.2	6.0	6.7
Alfalfa Silage	4.0	0.9	9.5
Barley Bran	15.2	5.2	14.9
Bluegrass Chaff	7.1	1.9	28.5
Bluegrass Screenings	6.7	2.0	26.1
Blackberry Seeds	9.6	---	---
Bread	12.5	5.3	0.7
Brewers Wet Grains	10.3	1.0	3.4
Buckwheat Feed & Hulls	9.6	2.9	22.4
Cake, Ground	4.8	9.9	1.5
Cob & Shuck Meal	3.2	0.6	31.6
Cookie Meal	7.7	8.6	0.8
Corn Dust	7.1	2.7	1.7
Corn Blowings	8.7	1.9	15.7
Corn Fodder & Soybean Plant	10.1	3.9	17.0
Cracklings, Edible	67.1	28.1	1.1
Cracklings, Inedible	44.1	22.2	3.0
Distillers Thin Slop	1.4	---	---
Fescue Silage	2.8	1.3	8.9
Honey Suckle	2.8	0.02	6.0
Ice Cream Cones, Ground	9.2	1.5	0.7
Johnson Grass	7.8	0.8	37.6
Kale Seed	24.3	40.0	9.6
Korean Hay	13.9	---	---
Korean Screenings	21.9	3.6	20.8
Lespedeza Screenings	19.8	15.7	26.2
Lima Beans, Ground	21.5	1.5	6.1
Malt Hulls, Ground	10.3	1.8	22.5
Osage Orange Apple	2.5	4.3	1.7
Peanut Vine Meal	10.1	2.3	34.0
Popcorn, Ground	9.4	2.5	2.7
Popcorn, Popped and Crushed	8.4	12.8	2.9
Potato Flour	2.0	---	---
Potato Flakes	9.0	---	---
Rag Weed Seed	17.2	16.2	34.4
Sorghum, Ground (Stalk & Leaves)	4.1	2.9	19.6
Ground Unthreshed Heads of Grain Sorghum	6.4	2.1	10.5
Fescue & Clover Silage	2.0	1.0	8.0
Oat Silage	1.9	1.5	9.8
Straw Silage	6.5	3.0	19.5
Sudan Grass Silage	5.9	1.1	14.0
Sudan & Soybean Silage	2.4	0.6	7.9
Vetch Seed	26.4	0.7	7.6
Walnut Shells & Meats	13.2	24.2	27.1
Walnut Meat Skins & Small Amount of Shell	21.5	45.5	12.0
Wheat Toast, Ground	12.6	4.9	0.5
Wild Onions	6.7	0.2	1.0
Wheat Silage	4.4	1.4	22.7

TABLE 1 REPORT OF OFFICIAL FEED SAMPLES ANALYZED, 1961

For samples not passed see Table 2

NAME AND ADDRESS OF MANUFACTURER	Number of Samples Analyzed and Examined	Number of Samples Passed	Number of Samples Not Passed
The Abilene Flour Mills, Co., Abilene, Kansas	3	3	
Acme - Evans Co., Inc., Indianapolis, Indiana	8	8	
W. G. Adams, Waynesburg, Kentucky	1	1	
Albany Mills, Albany, Kentucky	3	3	
Albers Milling Co., Los Angeles, California	8	8	
Allied Food Distributors, Inc., Atlanta, Ga.	5	4	1
Allied Mills, Inc., Chicago, Illinois	83	79	4
Altus Cotton Oil Mill, Altus, Oklahoma	1	1	
Anderson County Farm Service, Lawrenceburg, Kentucky	5	3	2
Anderson & Spilman, Danville, Kentucky	4	4	
Andrews Mills, Russellville, Kentucky	3	1	2
Anglo Sweet Feed Mill, Inc., Owensboro, Ky.	2	2	
Apex Feed and Supply, Inc., Marietta, Ohio	1	1	
Archer - Daniels - Midland Co., Minneapolis, Minnesota	5	5	
Arkansas Grain Corp., Stuttgart, Arkansas	1	1	
Ashland Milling Co., Inc., Ashland, Kentucky	2	2	
Aubrey Feed Mills, Inc., Louisville, Kentucky	157	126	31
The Auburn Mills, Auburn, Kentucky	12	7	5
Aylor & Meyer Co., Aurora, Indiana	8	6	2
Bagdad Roller Mills, Bagdad, Kentucky	73	60	13
Baltic Mills, Inc., Vincennes, Indiana	4	4	
Banner Feed Mills, Huntington, West Virginia	4	3	1
Bardstown Mill, Bardstown, Kentucky	6	5	1
Bardwell Milling Co., Bardwell, Kentucky	1	1	
Barnett Co., Harrodsburg, Kentucky	1	1	
Barry - Carter Milling Co., Lebanon, Tenn.	1	1	
Barton Distilling Co., Bardstown, Kentucky	8	8	
Bates Farm Supply, Dry Ridge, Kentucky	2	2	
Baughman Milling Co., Stanford, Kentucky	42	28	14
Bay State Milling, Winona, Minnesota	1	1	
James B. Beam Distilling Co., Clermont, Ky.	1	1	
B. A. Bernard & Co., Camden, New Jersey	1	1	
B. A. Bernard & Co., Philadelphia, Penn.	1		1
Best Feeds & Farm Supplies, Inc., Washington, Pennsylvania	2	2	
Big Jo Flour Mills, Minneapolis, Minnesota	2	2	
Bi-County Farm Bureau Coop., Florence, Ky.	11	10	1
Birmingham Milling Co., Benton, Kentucky	3	2	1
Bobb Brothers, Leesburg, Ohio	1		1
The Boswell Co., Atlanta, Georgia	1	1	
Boyle Packing Co., Danville, Kentucky	2		2
Bremco Alfalfa Mills, Inc., New Bremen, Ohio	3	3	
The Brode Corp., Memphis, Tennessee	3	2	1
Browder Milling Co., Fulton, Kentucky	11	8	3
Brown - Forman Distillers Corp., Louisville, Kentucky	1	1	
The Buckeye Cellulose Corp., Cincinnati, Ohio	5	4	1
Buhler Mills, Inc., Buhler, Kansas	1	1	
Buhner & Co., Inc., Louisville, Kentucky	24	16	8
Bundy Brothers Mill Co., Medora, Indiana	8	7	1
Burch Hester Feed Store, Hustonville, Ky.	2	2	
Burgess Bros. Mill, Sadieville, Kentucky	1	1	
Burjon Milling Co., Memphis, Tennessee	1	1	

TABLE 1 REPORT OF OFFICIAL FEED SAMPLES ANALYZED, 1961

For samples not passed see Table 2

NAME AND ADDRESS OF MANUFACTURER	Number of Samples Analyzed and Examined	Number of Samples Passed	Number of Samples Not Passed
Bush Brothers & Co., Clinton, Tennessee	3	3	
Cadiz Milling Co., Cadiz, Kentucky	24	11	13
Campbell & Co., Mattoon, Illinois	1		1
Campbell Wholesale Co., Combs, Kentucky	1		1
Caneyville Roller Mills, Caneyville, Kentucky	14	9	5
Cardinal Food Products, Inc., St. Louis, Mo.	5	1	4
Cargill, Inc., Minneapolis, Minnesota	1	1	
Carroll County Farm Bureau Coop., Carrollton, Kentucky	2	2	
Cat Life Packing Co., Chicago, Illinois	1	1	
Central Packing Co., Cape Girardeau, Mo.	1	1	
Central Soya Co., Ft. Wayne, Indiana	123	102	21
Chestnut & Anderson Feed & Supply, Hopkinsville, Kentucky	2	2	
Cincinnati Grain & Hay Co., Cincinnati, Ohio	2	1	1
City Roller Mills, Vevay, Indiana	2	2	
Checkasa Oil Mill, Inc., Memphis, Tennessee	1	1	
C & L Rice Mill, Inc., DeWitt, Arkansas	1	1	
Citizens Milling Co., Somerset, Kentucky	15	9	6
Clarkson Feed Store, Clarkson, Kentucky	3	1	2
Clifty Falls Mills, Inc., Madison, Indiana	40	26	14
Clinton Corn Processing Co., Clinton, Iowa	4	4	
Clinton Hatchery, Clinton, Kentucky	9	5	4
Clinton Milling Co., Clinton, Kentucky	40	34	6
Colby Milling Co., Abbotsford, Wisconsin	1	1	
H. C. Cole Milling Co., Chester, Illinois	8	6	2
Clell Coleman & Sons, Burgin, Kentucky	36	23	13
Collier Bros. Feed Mill, Hickory, Kentucky	1	1	
The Colorado Milling & Elevator Co., Denver, Colorado	3		3
Commander - Larabee Milling Co., Minneapolis, Minnesota	2	2	
Community Mills, Belton, Kentucky	4	2	2
Community Milling Co., Irvington, Kentucky	12	7	5
Consolidated Products, Danville, Illinois	1	1	
Cooper Brothers, Elizabethtown, Kentucky	1	1	
Cooperative Mills, Cincinnati, Ohio	182	162	20
Crescent Roller Mills, Taylorsville, Kentucky	15	10	5
Crestwood Farmers Supply Center, Crestwood, Kentucky	25	18	7
Custom Feed Mill, Morganfield, Kentucky	11	11	
The Dant Distillery Co., Gethsemane, Ky.	2	2	
H. H. Davis Co., Little Rock, Arkansas	2	2	
Delta Oil Mill, Inc., Jonestown, Mississippi	1	1	
Dori-Dri Co., Dundee, Illinois	1	1	
Darling & Co., Cincinnati, Ohio	1		1
Dearborn Mills, Aurora, Indiana	41	38	3
Decatur Cotton Oil Co., Decatur, Alabama	1		1
Decatur Elevator Co., Decatur, Illinois	3	3	
Deep Run Packing Co., Dublin, Pennsylvania	1		1
Dehydrator's Supply Co., Charleston, Mo.	1	1	
Delphas Grain & Soya Products Company Delphas, Ohio	1	1	Not Registered

TABLE 1 REPORT OF OFFICIAL FEED SAMPLES ANALYZED, 1961

For samples not passed see Table 2

NAME AND ADDRESS OF MANUFACTURER	Number of Samples Analyzed and Examined	Number of Samples Passed	Number of Samples Not Passed
W. C. Dicken, Mentor, Kentucky	13	11	2
Dinner Bell Dog Food Co., Battle Creek, Mich.	1	1	Not Registered
Dixie Mills Co. East St. Louis, Illinois	3	2	1
Dixie-Portland Flour Mills, Memphis, Tenn.	5	5	
Duncan's Farm Service, Lawrenceburg, Ky.	6	5	1
Dunnington Milling Co., Monticello, Kentucky	2	2	
Dyersburg Oil Mill Co., Dyer sburg, Tennessee	6	6	
The Early & Daniel Co., Cincinnati, Ohio	85	73	12
The F. L. Emmert Co., Cincinnati, Ohio	2	2	
John W. Eshelman & Sons, Lancaster, Penn.	20	19	1
Eshelman Grain, Inc., Columbus, Ohio	15	10	5
Ewing Milling Co., Brownstown, Indiana	3	3	
Fabro, Inc., Athens, Georgia	8	6	2
Famous Feed Mills, Nashville, Tennessee	33	23	10
Farmers Elevators, Inc., Owensboro, Kentucky	9	5	4
Farmers Elevator Co., Franklin, Kentucky	2	1	1
Farmers Feed Store, Central City, Kentucky	4	4	
Farmers Feed Mill, Lexington, Kentucky	1	1	
Farmers & Merchants Milling Co., Brooksville, Kentucky	5	4	1
Farmers Milling Co., Somerset, Kentucky	17	3	14
Farmers Supply, Beaver Dam, Kentucky	3	1	2
Farmers Supply & Produce Co., Monticello, Ky.	1	1	
Farmers Tankage Co., Henderson, Kentucky	1	1	
Farmers Union Mill, Versailles, Kentucky	3	1	2
Farm Services, Inc., Glasgow, Kentucky	1	1	
Farmington Sweet Feed Mill, Farmington, Ky.	1	1	
J. H. Fedder's, Inc., Covington, Kentucky	10	10	
Ferncliff Feed & Grain Co., Louisville, Ky.	34	29	5
Henry Fischer Packing Co., Louisville, Ky.	1	1	
Fischer Products Co., Inc., Jacksonville, Fla.	1	1	
Flambeau Milling Co., Phillips, Wisconsin	5	2	3
Folsomdale Milling Co., Boaz, Kentucky	5	5	
Food Products Co. of America, Chicago, Ill.	1	1	
Francis Wholesale Co., Prestonsburg, Ky.	7	6	1
French Sardine Co., Terminal Island, Calif.	1	1	
Frosty Morn Meats, Clarksville, Tennessee	3	3	
Henry Fruechtenicht Co., Louisville, Kentucky	123	98	25
Fruen Milling Co., Minneapolis, Minnesota	1	1	
Fuhrer-Ford Mill Co., Inc., Mt. Vernon, Ind.	24	9	15
Ft. Negley Mills, Nashville, Tennessee	1		1
Gallatin County Farm Supply, Warsaw, Ky.	3	3	
Garden Street Mill & Elevator Co., Louisville, Kentucky	3	3	
Garrard Mills, Lancaster, Kentucky	28	14	14
J. I. Gates Milling Co., Columbus, Ohio	2	1	1
General Distributors, South Ft. Mitchell, Ky.	5	2	3
General Foods Corp., Battle Creek, Michigan	1	1	
General Mills, Inc., Minneapolis, Minnesota	22	17	5
General Packing Co., Waynesville, Ohio	1	1	
Germantown Milling Co., Germantown, Ky.	1	1	
Glister Milling Co., Chester, Illinois	3	1	2
Glenmore Distilleries Co., Owensboro, Ky.	1	1	

TABLE 1 REPORT OF OFFICIAL FEED SAMPLES ANALYZED, 1961

For samples not passed see Table 2

NAME AND ADDRESS OF MANUFACTURER	Number of Samples Analyzed and Examined	Number of Samples Passed	Number of Samples Not Passed
Great Atlantic & Pacific Tea Co., New York, N. Y.	1	1	
Golden Rod Oil Sales Co., Memphis, Tennessee	4	4	
Gothenburg Feed Products Co., Gothenburg, Nebraska	1	1	
Green County Milling Co., Greensburg, Ky.	5	5	
Gwinn Brothers & Co., Huntington, West Va.	21	18	3
Hardin Feed Mill, Hardin Kentucky	3	3	
Hartz Mountain Products Corp., New York, N. Y.	2	2	
Harvest Brand, Inc., Pittsburg, Kansas	3	2	1
Hales & Hunter Co., Chicago, Illinois	27	23	4
Hardin County Milling Co., Elizabethtown, Ky.	7	5	2
Hardy Bros. Mill, Walton, Kentucky	9	7	2
Harpeth Mills, Nashville, Tennessee	3	1	2
Harrison Farm Supply, Berea, Kentucky	1	1	
The P. H. Harsha Milling Co., Portsmouth, Ohio	5	4	1
T. J. Haycraft's Sales & Service, Leitchfield, Kentucky	6	4	2
Hay Market Mills, Nashville, Tennessee	1		1
Haydon Mill & Grain Co., Springfield, Ky.	8	5	3
Heaven Hill Distilleries, Bardstown, Kentucky	7	7	
Henderson Feed & Commission Co., Henderson, Kentucky	1	1	
Burch Hester Feed Store, Hustonville, Ky.	2	2	
Dr. Heinz Co., Inc., Washington C. H., Ohio	17	16	1
T. G. Hill & Co., Atlanta, Georgia	2	2	
Hill Packing Co., Topeka, Kansas	3	3	
Hodgenville Roller Mill, Hodgenville, Kentucky	2		2
Home Milling Co., Greenville, Kentucky	31	13	18
Hopkinsville Milling Co., Hopkinsville, Ky.	11	11	
Hudson Farm Service, Franklin, Kentucky	4	4	
Hunter Packing Co., East St. Louis, Illinois	1	1	
Igleheart Brothers, Evansville, Indiana	11	10	1
Illinois Cereal Mills, Inc., Paris, Illinois	2	2	
Illinois Soy Products Co., Springfield, Illinois	4	4	
J. F. Imbs Milling Co., Belleville, Illinois	7	4	3
Independent Oil Mill, Inc., Jackson, Tennessee	1	1	
International Milling Co., Minneapolis, Minn.	3	3	
International Salt Co., Avery Island, La.	1	1	
Jones Packing Co., Paducah, Kentucky	2	2	
Keller Hay & Grain Co., Newport, Kentucky	6	4	2
Spencer Kellogg & Sons, Kansas City, Mo.	25	19	6
Kentucky By-Products Corp., Louisville, Ky.	10	10	
Kentucky Chemical Industries, Inc., Cincinnati, Ohio	1	1	
Keynes Brothers, Logan, Ohio	14	7	7
F. W. Kibler Milling Co., Mt. Orah, Ohio	1	1	
The Klarer Co., Louisville, Kentucky	5	4	1
Knifley Feed & Supply Co., Elkhorn, Kentucky	4	4	
Kuder Pulp Sales Co., Lake Alfred, Florida	1	1	

TABLE 1 REPORT OF OFFICIAL FEED SAMPLES ANALYZED, 1961

For samples not passed see Table 2

NAME AND ADDRESS OF MANUFACTURER	Number of Samples Analyzed and Examined	Number of Samples Passed	Number of Samples Not Passed
LaCross Milling Co., Cockrane, Wisconsin	1	1	
Lake County Oil Mill, Tiptonville, Tennessee	8	4	4
Edmond J. Lang New York, N. Y.	1		1
Laswell Milling Co., Brodhead, Kentucky	2	2	
Lauhoff Grain Co., Danville, Illinois	2	2	
Lee Dog Food Co., LaGrange, Kentucky	1		1
Lewisburg Roller Mill, Lewisburg, Kentucky	9	6	3
Lexington Roller Mill, Lexington, Kentucky	37	33	4
Life Guard Feeds, Columbus, Ohio	11	10	1
Lilly Brothers Seed Co., Hopkinsville, Kentucky	6	5	1
The Lindon Mills, Columbus, Ohio	1	1	
Lipscomb Farm Supply, Walton, Kentucky	2	1	1
Lofton's Feed & Grain, Clay, Kentucky	1	1	
London Feed & Milling Co., London, Kentucky	1	1	
Louisa Supply Co., Louisa, Kentucky	9	9	
Lovelaceville Feed Mill, Lovelaceville, Ky.	5	5	
L. B. Lovitt & Co., Memphis, Tennessee	4	4	
Lowe's Feed & Hatchery, Bowling Green, Ky.	13	6	7
Lyon & Greenleaf Co., Inc., Ligonier, Indiana	1	1	
Magic Feed Mills, Inc., Paoli, Indiana	2	2	
Marianna Sales Co., Memphis, Tennessee	1	1	
Markin Feed Co., Ironton, Ohio	1		1
Martin Sales Co., Toledo, Ohio	1	1	
Mayfield Milling Co., Inc., Mayfield, Kentucky	44	40	4
Mayfield Sweet Feed Mill, Mayfield, Kentucky	18	18	
McCarley & Richardson, Inc., Russellville, Ky.	1	1	
McCauley Bros. Seed Co., Versailles, Ky.	3	2	1
McGahan Feed Co., Paintsville, Kentucky	3	1	2
McKnight Keaton Grocery Co., Sikeston, Mo.	5	4	1
McMillen Feed Mills, Ft. Wayne, Indiana	5	4	1
McRedmond Bros., Inc., Nashville, Tennessee	1	1	
McWhorter Brothers, Albany, Kentucky	2	2	
Meadows Feed & Building Supply, Clay City, Ky.	9	7	2
The Mennel Milling Co., Fostoria, Ohio	2	2	
Metzger Bros., Paducah, Kentucky	4		4
Michigan Salt Co., St. Louis, Michigan	1	1	
Middlesboro Milling Co., Middlesboro, Ky.	13	12	1
Mid West Cooperative Oil Mill, Hamlin, Texas	2	2	Not Registered
Midget Mill, Somerset, Kentucky	6	2	4
J. E. Mighton Co., Bedford, Ohio	6	5	1
Miller Milling Service, Bowling Green, Ky.	1		1
Milliken Sweet Feed Mill, Franklin, Kentucky	3	2	1
Mineral Products Co., Indianapolis, Indiana	1		1
Minten City Oil Mill, Minten City, Mississippi	2	2	Not Registered
Model Mills, Georgetown, Kentucky	1	1	
Monarch Milling Co., Mt. Sterling, Kentucky	6	1	5
Moore - Lowry Flour Mills, Coffeyville, Kan.	4	4	
Moorman Manufacturing Co., Quincy, Illinois	8	8	
Mohawk Roller Mill, Mohawk, Tennessee	1	1	
August Moldenhauer Mill, Menfro, Missouri	1	1	
Monroe Bros. Sweet Feed Mill, Cave City, Ky.	2	2	
Morgan Packing Co., Austin, Indiana	3	3	
Morgantown Feed Mill, Morgantown, Kentucky	5	3	2
John Morrell & Co., Chicago, Illinois	1	1	

TABLE 1 REPORT OF OFFICIAL FEED SAMPLES ANALYZED, 1961

For samples not passed see Table 2

NAME AND ADDRESS OF MANUFACTURER	Number of Samples Analyzed and Examined	Number of Samples Passed	Number of Samples Not Passed
Morristown Milling Co., Morristown, Tennessee	1	1	
Morton Salt Co., Chicago, Illinois	1	1	
Mount Vernon Milling Co., Mt. Vernon, Indiana	6	6	
Murphy Grain & Milling Co., Owensboro, Ky.	4	4	
Myers & Clark Milling Co., Ashland, Kentucky	8	7	1
Henry Nagel & Son, Cincinnati, Ohio	3	3	
Nall Bros. Feed Mill, Vine Grove, Kentucky	1		1
Nashville Cotton Oil Corp., Nashville, Tenn.	5	5	
National Alfalfa Dehydrating & Milling Co., LaMar, Colorado	2	1	1
National Biscuit Co., Toledo, Ohio	2	2	
National Distillers Products Co., New York, N. Y.	1		1
National Oats Co., East St. Louis, Illinois	37	32	5
Nebo Mill, Nebo, Kentucky	1	1	
Neumond, Inc., St. Louis, Missouri	2	2	
The New Era Milling Co., Arkansas City, Kan.	5	4	1
The North American Trading & Import Co., Philadelphia, Pennsylvania	2	1	1
Charles Nunn & Sons Milling Co., Evansville, Indiana	25	22	3
Nutrena Mills, Inc., Minneapolis, Minnesota	3	2	1
Ohio Blenders, Inc., Toledo, Ohio	1	1	
Ohio Valley Soybean Coop., Henderson, Ky.	29	28	1
Orleans Dog Candy Co., Chicago, Illinois	1		1
Owensboro Grain Co., Owensboro, Kentucky	17	14	3
Owensboro Milling Co., Owensboro, Kentucky	27	26	1
Pittsburg Plate Glass Co., Red Wing, Minnesota	1	1	
Pan American Mills, Bowling Green, Kentucky	14	8	6
Patterson & Guthrie, Harrodsburg, Kentucky	3	3	
Stanley Penn & Sons, Lexington, Kentucky	1	1	
Pennington Milling Co., Pennington Gap, Va.	6	6	
Pierce & Williams, Hopkinsville, Kentucky	7	5	2
The Pillsbury Co., Minneapolis, Minnesota	47	40	7
Plains Cooperative Oil Mill, Lubbock, Texas	1	1	
Planters Manufacturing Co., Clarksdale, Miss.	1	1	
Princeton Mill, Princeton, Kentucky	7	4	3
Proviso Feed & Concentrates, Botkins, Ohio	1	1	
Quaker Oats Co., Chicago, Illinois	25	22	3
Ralston Purina Co., St. Louis Missouri	213	196	17
Randolph Milling Co., Bandana, Kentucky	5	3	2
Raymondville Cotton Oil Co., Raymondville, Texas	1	1	
Reelfoot Alfalfa Mill, Tiptonville, Tennessee	9	6	3
Ringold Milling Co., Clarksville, Tennessee	1	1	
Rival Packing Co., Chicago, Illinois	1	1	
Robbins Bros., Auburn, Kentucky	7		7
Robinson Milling Co., Inc., Somerset, Ky.	36	26	10
Rogers Feed Store, Corinth, Kentucky	6	5	1
Rome Oil Mill, Rome, Georgia	2	2	

TABLE 1 REPORT OF OFFICIAL FEED SAMPLES ANALYZED, 1961

For samples not passed see Table 2

NAME AND ADDRESS OF MANUFACTURER	Number of Samples Analyzed and Examined	Number of Samples Passed	Number of Samples Not Passed
G. P. Rose & Co., Nashville, Tennessee	2	2	
Ross Feed Co., Murray, Kentucky	7	7	
Russell Springs Milling Co., Russell Springs, Kentucky	1	1	
Russellville Feed Co., Russellville, Kentucky	15	8	7
Russells Co., Hilliard, Ohio	3	3	
Ryde & Co., Chicago, Illinois	1	1	
Salyersville Wholesale, Inc., Salyersville, Ky.	3	3	
Sandusky Bros., Harrodsburg, Kentucky	9	4	5
J. F. Schneider & Son, Inc., Middlesboro, Ky.	1	1	
Charles H. Schenk & Sons, Vincennes, Indiana	4	4	
Schenley Distillers, Inc., Frankfort, Kentucky	4	4	
John Schlemmer, Harrison, Ohio	1	1	
The Scott County Milling Co., Sikeston, Mo.	17	15	2
Joseph E. Seagram & Sons, Inc., New York, N. Y.	2	2	
Security Mills, Inc., Knoxville, Tennessee	3	3	
Sikeston Cotton Oil Mill, Inc., Sikeston, Mo.	4	4	
J. Allen Smith & Co., Knoxville, Tennessee	5	5	
Smithfield Milling Co., Smithfield, Kentucky	1	1	
Southern Cotton Oil Division, Decatur, Alabama	1	1	
Southern Cotton Oil Division, Macon, Georgia	1	1	
Southern Rendering Co., Shelbyville, Tennessee	2	1	1
Southern States LaGrange Coop., LaGrange, Ky.	3	3	
Southern States Clark Coop., Winchester, Ky.	3	3	
Southern States Glasgow Coop., Glasgow, Ky.	6	3	3
Southern States Owenton Coop., Owenton, Ky.	1	1	
Southern States Leitchfield Coop., Leitchfield, Kentucky	6	4	2
Southern States Russellville Coop., Russellville, Kentucky	1	1	
Southern States Frankfort Coop., Frankfort, Kentucky	2	2	
Southern States Hopkinsville Coop., Hopkinsville, Kentucky	7	1	6
Southern States Shelbyville Coop., Shelbyville, Kentucky	1	1	
Southern States Cooperative, Richmond, Va.	3	3	
Southland Cotton Oil Co., Shreveport, La.	2	1	1
Woodford Spears & Sons, Paris, Kentucky	8	6	2
Spen - Well Feed Co., Winchester, Kentucky	20	11	9
Sportsman Dog Food Co., Chicago, Illinois	1	1	
A. E. Staley Manufacturing Co., Decatur, Ill.	5	2	3
Standard Mills, Huntington, West Virginia	1	1	
Stewart's Feed Mill, Flat Lick, Kentucky	4	3	1
F. W. Stock & Sons, Hillsdale, Michigan	1	1	
Sturgis Milling Co., Sturgis, Kentucky	22	15	7
Sun-Ray Feed Mills, Bowling Green, Kentucky	13	5	8
Sun-Ray Feed Mills, Lexington, Kentucky	2	2	
Sunshine Biscuits, Inc., Grafton, Ohio	2	2	
Supreme Mills, Glasgow, Kentucky	68	38	30
D. B. Sutherland & Sons, Bloomfield, Kentucky	23	16	7
Sweet Feed Mill, Inc., Bowling Green, Ky.	1	1	
Swift & Co., Chicago, Illinois	8	7	1

TABLE 1 REPORT OF OFFICIAL FEED SAMPLES ANALYZED, 1961

For samples not passed see Table 2

NAME AND ADDRESS OF MANUFACTURER	Number of Samples Analyzed and Examined	Number of Samples Passed	Number of Samples Not Passed
T. H. Feed Service, Lebanon, Kentucky	1		1
Tabor Hatchery & Building Supply, Columbia, Kentucky	3	3	
Taylor County Implement & Feed Co., Campbellsville, Kentucky	2	2	
Tennessee - Kentucky Alfalfa Mill, Tiptonville, Tennessee	1	1	
The Thorobred Co., Inc., Waynesville, Ohio	3	2	1
Thurmonds Coal & Feed Co., Murray, Kentucky	4	3	1
Todd County Grain Co., Elkton, Kentucky	7	4	3
Traders Oil Mill Co., Fort Worth, Texas	2	1	1
Trenton Cotton Oil Co., Trenton, Tennessee	11	10	1
Trenton Milling Co., Trenton, Illinois	5	4	1
Tri-State Molasses Co., Owensboro, Ky.	1	1	
Tri-State Mills, Kenova, W. Va.	4	4	
Usen Canning Co., Boston, Massachusetts	2	2	
Van Camp Sea Food Co., Port of Long Beach, California	1	1	Not Registered
VyLactos Laboratories, Inc., DesMoines, Iowa	1	1	
Earl Ward's Mill, Paducah, Kentucky	1	1	
Walters & Thompson, Shelbyville, Kentucky	5	4	1
Warner's Farm Supply, Somerset, Kentucky	2	1	1
Western Grain Co., Birmingham, Alabama	2	2	
Weisenberger Mills, Midway, Kentucky	5	4	1
Ralph Wells & Co., Monmouth, Illinois	1	1	
West Tennessee Soya Mills, Tiptonville, Tennessee	10	10	
Gardner White, Princeton, Kentucky	2	1	1
Martha White Mill of W. Va. Huntington, W. Va.	28	27	1
The Whitewater Flour Mill Co. Whitewater, Kansas	4	3	1
The George Weidemann Brewing Co., Newport, Kentucky	2	2	
Williamstown Roller Mills, Williamstown, Ky.	11	7	4
Winn Milling Co., Greensburg, Kentucky	7	5	2
Woodford Feed Co., Versailles, Kentucky	2	1	1
Woolcott Mills, Inc., Lexington, Kentucky	3	2	1
TOTALS	3,316	2,629	687
		79%	21%

TABLE 2 SAMPLES CLASSIFIED AS "NOT PASSED"

MANUFACTURER, ADDRESS AND BRAND	GUARANTEED	FOUND
Allied Food Distributors, Inc., Atlanta, Georgia Streak Dog Food	Crude Fat 2.0%	0.9%
Allied Mills, Inc., Chicago, Illinois Wayne Pig Balancer Medicated N-29	Crude Protein 40.0%	37.8%
Wayne's Egg Medicated M-29	Crude Fat 4.0%	2.9%
Wayne 50% Dairy Concentrate	N. P. N. (Urea) 26.0%	27.9%
Wayne Egg Producer	Salt 0.9%	1.9%
Anderson County Farm Service, Lawrenceburg, Ky. Horse & Mule Feed	Crude Protein 12.0%	9.3%
Anderson County 16% Dairy Feed		Unground weed seeds
Andrews Mills, Russellville, Kentucky Super 20% Chick Starter Mash Medicated	Arsanilic Acid 0.01%	0.005%
Super 40% Hog Supplement	Salt 1.5%	2.36%
Aubrey Feed Mill, Inc. Louisville, Kentucky Red A Starter & Grower Medicated	Crude Fiber 6.0%	6.9%
Red A Commercial Layer	Crude Protein 16.0%	15.4%
Red A Commercial Layer	Crude Fiber 5.0%	5.8%
Red A Super High Energy Broiler Ration Medicated	Crude Protein 22.5%	21.4%
Red A 44% Dairy Supplement	Crude Protein 44.0%	42.3%
Red A 32% Dairy Supplement	Crude Fat 3.0%	1.8%
Red A 32% Dairy Supplement	Crude Fat 3.0%	2.4%
Red A 32% Dairy Supplement	Crude Fat 3.0%	2.3%
Red A 24% Dairy Feed	Crude Protein 24.0%	23.3%
Red A 18% Dairy Feed	Crude Protein 18.0%	17.3%
Aubrey's Special 16 1/2 Dairy Feed	Crude Protein 16.5%	15.6%
Red A 33% Beef Cattle Concentrate	Crude Fiber 6.0%	7.2%
Red A 40% Hog Supplement Medicated	3-Nitro-4 0.0125%	0.0094%
Red A 40% Hog Supplement Medicated	3-Nitro-4 0.0125%	0.0094%
Red A 40% Hog Supplement Medicated	3-Nitro-4 0.0125%	0.0095%
Red A 40% Hog Supplement Medicated	3-Nitro-4 0.0125%	0.0082%
Red A 40% Hog Supplement Medicated	3-Nitro-4 0.0125%	0.0097%
Red A 40% Hog Supplement Medicated	3-Nitro-4-0.0125%	0.0078%
Aubrey's Special 40% Hog Supplement Med.	Crude Protein 40.0%	39.4%
Aubrey's Special 40% Hog Supplement Medicated	3-Nitro-4 0.0125%	0.0097%
Aubrey's Special 40% Hog Supplement Medicated	3-Nitro-4 0.0125%	0.0097%
Aubrey's Special 40% Hog Supplement Medicated	3-Nitro-4 0.0125%	0.0094%
Aubrey's Special 40% Hog Supplement	Crude Protein 40.0%	39.2%
Red A 35% Sow & Pig Supplement Medicated	3-Nitro-4 0.01%	0.0061%
Red A 35% Sow & Pig Supplement Medicated	3-Nitro-4 0.01%	0.0075%
Red A Pig Starter Pellets	Crude Fat 4.7%	3.3%
Red A Pig Starter Pellets	Crude Fat 4.7%	3.7%
Red A 16% Sow & Pig Feed Medicated	3-Nitro-4 0.0025%	0.0018%
Red A 16% Sow & Pig Feed Medicated	3-Nitro-4 0.0025%	0.004%
Red A 16% Sow & Pig Feed Medicated	3-Nitro-4 0.0025%	0.0016%
Red A 16% Sow & Pig Feed Medicated	3-Nitro-4 0.0025%	0.0018%
Red A Wheat Shorts with Screening	Crude Fiber 7.0%	7.7%
The Auburn Mills Auburn Kentucky Leader Mixed Feed	Crude Protein 14.0%	13.2%
Leader Mixed Feed	Crude Protein 14.0%	11.8%
Leader Mixed Feed	Crude Protein 14.0%	12.6%
Leader Mixed Feed	Crude Fat 3.5%	2.8%
Leader Mixed Feed		Unground weed seeds

TABLE 2 SAMPLES CLASSIFIED AS "NOT PASSED"

MANUFACTURER, ADDRESS AND BRAND	GUARANTEED	FOUND
Aylor & Meyer Co., Aurora, Indiana Rainbow 24% Dairy Hominy Feed	Crude Protein 24.0% Crude Fat 5.0%	22.8% 3.6%
Bagdad Roller Mills, Bagdad, Kentucky Rocket Age 16% Shoat Grower Medicated Rocket Age 44% Dairy Concentrate Rocket Age 44% Dairy Concentrate Rocket Age 44% Dairy Concentrate Rocket Age 44% Dairy Concentrate Rocket Age 44% Dairy Concentrate Rocket Age 44% Dairy Concentrate Rocket Age 44% Dairy Concentrate Rocket Age 44% Dairy Concentrate Rocket Age 16% Dairy Feed Rocket Age 16% Dairy Feed Harrison's 16% Dairy Feed Rocket Age 40% Hog Concentrate Rocket Age 40% Hog Concentrate	Arsanilic Acid 0.01% Crude Protein 44.0% Crude Protein 44.0% Crude Protein 44.0% Crude Protein 44.0% N. P. N. (Urea) 20.0% N. P. N. (Urea) 20.0% N. P. N. (Urea) 20.0% Crude Protein 16.0% Crude Protein 16.0% Crude Protein 16.0% Crude Fat 3.0% Crude Fat 3.0%	0.0067% 43.3% 41.6% 36.6% 42.4% 25.1% 21.5% 21.9% 13.9% 15.3% 15.3% 2.1% 2.1%
Banner Feed Mills, Huntington, West Virginia 16% Yellow Tag Sweet Mixing Feed		Unground weed seeds
Bardstown Mill, Bardstown, Kentucky Blue Ribbon 16% Dairy Feed	Crude Fiber 15.0%	17.1%
Baughman Milling Co., Stanford, Kentucky Banner 20% Starting & Growing Mash Banner 20% Laying Mash Banner Chick Feed	Crude Protein 20.0% Crude Protein 20.0%	15.9% 15.6%
Big B Hen Feed		Unground weed seeds
Big B Hen Feed		Unground weed seeds
Big B Hen Feed		Unground weed seeds
Big B Hen Feed		Unground weed seeds
Big B Hen Feed		Unground weed seeds
Big B Hen Feed		Unground weed seeds
Big B 24% Dairy Feed Big B 24% Dairy Feed	Crude Protein 24.0%	22.7% Unground weed seeds
Big B 24% Dairy Feed Banner Special 16% Dairy Feed Banner Pig & Sow Meal	Crude Protein 24.0% Crude Protein 16.0% Crude Fiber 6.0%	23.0% 13.5% 6.8%
B. A. Bernard & Co., Philadelphia, Pennsylvania Trim Dog Food	Crude Fat 4.0%	10.69%
Bi-County Farm Bureau Coop., Florence, Ky. Co-op Special Sheep or Calf 12% Feed	Crude Protein 12.0%	11.1%
Birmingham Milling Co., Benton, Kentucky Ground Wheat	Crude Protein 12.0%	9.8%
Bobb Brothers, Leesburg, Ohio Chick'N Scratch		Unground weed seeds
Boyle Packing Co., Danville, Kentucky Pride of Boyle Tankage Pride of Boyle Tankage	Crude Protein 45.0% Crude Protein 45.0%	40.8% 41.2%
The Brode Corp., Memphis, Tennessee Owl 41% Cottonseed Meal	Crude Protein 41.0%	40.0%

TABLE 2 SAMPLES CLASSIFIED AS "NOT PASSED"

MANUFACTURER, ADDRESS AND BRAND	GUARANTEED	FOUND
Browder Milling Co., Fulton, Kentucky		
Browder's 40% Hog Supplement Medicated	Calcium 2.4%	5.48%
Browder's 40% Hog Supplement Medicated	Crude Protein 40.0%	39.4%
Browder's 35% Pig & Hog Supplement Medicated		
	Crude Protein 35.0%	34.4%
	Salt 2.0%	2.89%
The Buckeye Cellulose Corp. Cincinnati, Ohio		
Buckeye 41% Cottonseed Meal	Crude Fiber 14.0%	14.6%
Buhner & Co. Inc., Louisville, Kentucky		
Happy Farmer Broiler Pre-starter Medicated	Crude Fat 7.0%	6.2%
Happy Farmer 20% Broiler Feed	Crude Protein 20.0%	15.6%
Happy Farmer 20% Broiler Feed	Nicarbazin 0.0125%	0.0095%
Happy Farmer 18% Laying Ration	Crude Fat 4.0%	3.1%
Happy Farmer 40% Hog Supplement Medicated	Salt 2.3%	3.0%
	Arsanilic Acid 0.05%	0.0385%
Happy Farmer 40% Hog Supplement Medicated	Crude Protein 40.0%	39.3%
Happy Farmer Sow Ration	Crude Fiber 8.0%	9.5%
Happy Farmer Sow Ration	Crude Fiber 8.0%	8.8%
Happy Farmer Hog Fattener Medicated	Arsanilic Acid 0.01%	0.0076%
Bundy Brothers Mill Co., Medora, Indiana		
Bundy's Dog Food	Crude Protein 25.0%	24.1%
Cadiz Milling Co., Cadiz, Kentucky		
Sunbeam Jr. 40% Hog Supplement	Calcium 4.5%	2.49%
Sunbeam Jr. 40% Hog Supplement	Calcium 4.5%	2.75%
Sunbeam Jr. 40% Hog Supplement	Calcium 4.5%	3.16%
Sunbeam Jr. 40% Hog Supplement	Calcium 4.5%	2.77%
Sunbeam 40% Hog Supplement	Crude Fat 2.0%	1.3%
	Calcium 4.0%	2.56%
	Calcium 4.0%	3.20%
Sunbeam 40% Hog Supplement	Crude Protein 40.0%	35.8%
Sunbeam 40% Hog Supplement	Crude Protein 35.0%	33.2%
Sunbeam 35% Sow & Pig Supplement	Crude Fat 3.5%	2.3%
Sunbeam 35% Sow & Pig Supplement	Crude Protein 35.0%	33.4%
Sunbeam 35% Sow & Pig Supplement	Crude Fat 3.5%	1.5%
Sunbeam 35% Sow & Pig Supplement	Crude Fat 3.5%	1.7%
Sunbeam 35% Sow & Pig Supplement	3-Nitro-4 0.007%	0.0007%
Check-R-Mix Pig Starter 3AB Medicated	3-Nitro-4 0.007%	0.002%
Check-R-Mix Pig Starter 3AB Medicated		
Campbell & Co., Inc., Mattoon, Illinois		
Knight's Dog Food	Crude Fat 5.0%	14.0%
Campbell Wholesale Co., Combs, Kentucky		
Johns Stock Feed	Crude Fat 4.0%	3.2%
Caneyville Roller Mills, Caneyville, Kentucky		
Kentucky Farm 40% Dairy Supplement	Calcium 5.0%	3.1%
Kentucky Farm 40% Dairy Supplement	Calcium 5.0%	3.81%
Kentucky Farm 40% Dairy Supplement	Calcium 5.0%	3.0%
Kentucky Farm 40% Dairy Supplement	Crude Protein 18.0%	16.4%
Kentucky Farm 18% Hog Fattening Feed	Crude Protein 18.0%	16.7%
Kentucky Farm 18% Hog Fattening Feed		
Cardinal Food Products, Inc., St. Louis, Missouri		
Pointer Dog Food	Crude Fat 2.0%	1.1%
Pointer Dog Food	Crude Fat 2.0%	1.0%
Pointer Dog Food	Crude Fat 2.0%	0.9%
Pointer Dog Food	Crude Fat 2.0%	1.3%
Central Soya Co., Ft. Wayne, Indiana		
Master Mix Pig Grower Concentrate Medicated	Arsanilic Acid 0.054	0.035%
Master Mix 40% Hog Concentrate	Crude Protein 40.0%	38.6%
Master Mix 35% Hog Concentrate	Crude Protein 35.0%	34.4%
Master Mix 35% Hog Concentrate	Crude Protein 35.0%	33.4%
Master Mix 35% Hog Concentrate	Crude Fiber 9.0%	9.8%

TABLE 2 SAMPLES CLASSIFIED AS "NOT PASSED"

MANUFACTURER, ADDRESS AND BRAND	GUARANTEED	FOUND
Master Mix 35% Hog Concentrate	Crude Protein 35.0%	33.7%
Master Mix 35% Hog Concentrate	Crude Protein 35.0%	34.4%
Master Mix Farro-aid 180 (829-19 D) Medicated	Furazolidone 0.0165%	0.0073%
Soybran Brand Flaked Soybean Hulls	Crude Protein 9.0%	8.2%
Master Mix Turkey Grower Concentrate Medicated	Ureidobenzene Arsonic Acid 0.1068	0.0768%
Master Mix Turkey Grower Concentrate Medicated	Arsonic Acid 0.15%	0.1170%
Master Mix 50% Dairy Concentrate	Crude Protein 50.0%	48.0%
Master Mix 50% Dairy Concentrate	Crude Protein 50.0%	47.5%
Master Mix 50% Dairy Concentrate	Crude Protein 50.0%	48.8%
	Crude Fiber 6.0%	6.6%
Master Mix 50% Dairy Concentrate	Crude Protein 50.0%	48.3%
Master Mix 50% Dairy Mixer	Crude Protein 50.0%	49.1%
Master Mix 38% Dairy Concentrate	Crude Protein 38.0%	36.8%
Master Mix 38% Dairy Concentrate	Crude Protein 38.0%	36.7%
Master Mix Big M Dairy Feed	Crude Fiber 15.0%	16.9%
Master Mix Sweet Bulk-N Flakes	Crude Fiber 18.0%	19.8%
Master Mix Sweet Bulk-N Flakes	Crude Fiber 18.0%	19.8%
Master Mix 32% Steer Mixer	Crude Protein 32.0%	31.3%
Cincinnati Grain & Hay Co., Cincinnati, Ohio Oat Mill By-product		Unground weed seeds
Citizens Milling Co., Somerset, Kentucky		
Cumberland 24% Dairy Feed	Crude Protein 24.0%	23.0%
Cumberland 24% Dairy Feed	N. P. N. (Urea) 8.3%	9.7%
Cumberland 24% Dairy Feed	N. P. N. (Urea) 8.3%	11.7%
Cumberland 24% Dairy Feed	N. P. N. (Urea) 8.3%	10.3%
Cumberland 24% Dairy Feed	N. P. N. (Urea) 8.3%	10.8%
Cumberland 16% Dairy Feed	N. P. N. (Urea) 5.24%	7.8%
Clarkson Feed Store, Clarkson, Kentucky		
Van Meter 20% Laying Mash	Crude Protein 20.0%	18.6%
Van Meter 20% Laying Mash	Crude Protein 20.0%	19.4%
Clifty Falls Mills Inc., Madison, Indiana		
Clifty Falls 20% Egg Mash	Crude Fat 3.0%	2.2%
Clifty Falls 24% Cow Feed	Crude Fat 2.5%	1.8%
Clifty Falls 24% Cow Feed		Unground weed seeds
Clifty Falls 20% Pusher Feed	Crude Protein 20.0%	17.1%
Clifty Falls 16% Pusher Feed		Unground weed seeds
Clifty Falls 16% Cow Feed	N. P. N. (Urea) 5.24%	8.2%
Clifty Falls 16% Cow Feed	Crude Fat 2.5%	1.7%
Clifty Falls 40% Hog Supplement	Crude Fiber 7.0%	7.6%
Clifty Falls 40% Hog Supplement	Calcium 4.0%	2.77%
Clifty Falls 18% Pig & Sow Feed	Crude Fiber 6.0%	7.3%
Clifty Falls 18% Pig & Sow Feed	Crude Fiber 6.0%	8.0%
Clifty Falls 10% Horse & Mule Feed	Crude Protein 10.0%	9.4%
Clifty Falls 10% Horse & Mule Feed	Crude Protein 10.0%	9.1%
Crushed Ear Corn & Molasses		Unground weed seeds
Clinton Hatchery Clinton, Kentucky		
New Deal 17% Cow Feed	Crude Fat 3.5%	2.0%
New Deal 17% Cow Feed	Crude Fat 3.5%	2.6%
New Deal 17% Cow Feed	Crude Fat 3.5%	2.4%
New Deal 17% Cow Feed	Crude Protein 17.0%	16.3%
New Deal 18% Pig & Sow Feed Medicated	3-Nitro-4 0.0025%	0.0171%

TABLE 2 SAMPLES CLASSIFIED AS "NOT PASSED"

MANUFACTURER, ADDRESS AND BRAND	GUARANTEED	FOUND
Clinton Milling Co., Clinton, Kentucky		
Masco 28% Turkey Starter	Crude Protein 28.0%	23.2%
Masco 20% Layer Medicated	3-Nitro-4 0.0075%	0.0065%
Masco 16% Milking Dairy Feed	Crude Protein 16.0%	14.5%
Masco 40% Hog Supplement Medicated	3-Nitro-4 0.0125%	0.0005%
Masco Pig Pre-Starter Medicated	Crude Fat 4.0%	3.3%
Masco 12% Hog Finisher Medicated	3-Nitro-4 0.0025%	0.00017%
H. C. Cole Milling Co., Chester Illinois		
Omega Wheat Shorts & Screenings	Crude Fiber 6.0%	6.7%
Omega Wheat Shorts & Screenings	Crude Fiber 6.0%	8.5%
Clell Coleman & Sons, Burgin, Kentucky		
Big Blue Stock Feed	Crude Protein 16.5%	15.8%
Big Blue Stock Feed	Crude Protein 16.5%	14.9%
	Crude Fat 4.0%	3.3%
Wheat Mill Run with Screenings	Crude Protein 13.0%	11.7%
Favorite Feed	Crude Protein 15.0%	12.8%
Coleman's Farm Feed	Crude Protein 14.0%	13.0%
	Crude Fat 4.0%	3.3%
Coleman's Farm Feed	Crude Protein 14.0%	13.5%
	Crude Fat 4.0%	3.2%
Coleman's Farm Feed	Crude Protein 14.0%	13.4%
	Crude Fat 4.0%	3.4%
Coleman's Farm Feed	Crude Protein 14.0%	12.8%
Coleman's Farm Feed	Crude Fat 4.0%	3.4%
Coleman's Farm Feed	Crude Fat 4.0%	3.1%
Coleman's Farm Feed	Crude Fat 4.0%	3.3%
Coleman's Hominy Feed	Crude Protein 9.0%	8.0%
Coleman's Pig & Hog Feed	Crude Protein 16.5%	15.8%
The Colorado Milling & Elevator Co., Denver Colo.		
Wheat Shorts	Crude Protein 16.0%	14.6%
Wheat Shorts	Crude Protein 16.0%	14.4%
Wheat Shorts	Crude Protein 16.0%	15.3%
Community Mills, Belton, Kentucky		
Brigance Egg Mash	Crude Protein 20.0%	19.2%
Brigance Egg Mash	Crude Protein 20.0%	19.2%
Community Milling Co., Irvington Kentucky		
Our Pride 20% All Mash Starter & Grower	Crude Protein 20.0%	19.2%
Our Pride 32% Dairy Supplement	Crude Fat 3.0%	2.0%
Our Pride 20% Dairy Feed	Crude Protein 20.0%	19.0%
Our Pride 20% Dairy Feed	Crude Protein 20.0%	19.4%
None Such 16% Dairy Feed	Crude Protein 16.0%	15.0%
	Crude Fat 2.5%	1.8%
Cooperative Mill, Cincinnati, Ohio		
40% Poultry Supplement Medicated	Arsanilic Acid 0.035%	0.027%
Hi-Fiber Pullet Developer	Crude Protein 12.0%	11.4%
Pro-Blend "50"	Crude Protein 50.0%	49.1%
Pro-Blend "50"	Crude Protein 50.0%	48.6%
Pro-Blend "50"	Crude Protein 50.0%	49.4%
Pro-Blend "50"	Crude Protein 50.0%	49.3%
32% Dairy Supplement	N. P. N. (Urea) 11.0%	16.4%
32% Dairy Supplement	N. P. N. (Urea) 11.0%	13.8%
16% Production Dairy	N. P. N. (Urea) 5.33%	6.8%
Beef Supplement	N. P. N. (Urea) 8.0%	11.0%
Beef Supplement	N. P. N. (Urea) 8.0%	9.6%
Beef Supplement	N. P. N. (Urea) 8.0%	9.7%
Beef Supplement	N. P. N. (Urea) 8.0%	9.5%
Beef Supplement	N. P. N. (Urea) 8.0%	10.3%
Beef Supplement	N. P. N. (Urea) 8.0%	9.6%
Beef Supplement	N. P. N. (Urea) 8.0%	9.4%
Beef Supplement	Crude Fiber 11.0%	11.8%
0.0011% Diethylstilbestrol Mixture in 30% Beef Maker	N. P. N. (Urea) 8.0%	10.1%

TABLE 2 SAMPLES CLASSIFIED AS "NOT PASSED"

MANUFACTURER, ADDRESS AND BRAND	GUARANTEED	FOUND
Pig Starter Medicated	Arsanilic Acid 0.01%	0.007%
Pig Pre-Starter Medicated	Arsanilic Acid 0.01%	0.0076%
Crescent Roller Mills, Taylorsville, Kentucky		
Crescent 50% Dairy Supplement	N. P. N. (Urea) 20.96%	24.5%
Crescent 50% Dairy Supplement	Crude Protein 50.0%	45.2%
Crescent 16 1/2 Dairy Feed	Crude Protein 16.5%	14.4%
Crescent 16 1/2 Dairy Feed	Crude Protein 16.5%	14.2%
Crescent Stock Feed	Crude Protein 14.0%	12.9%
Crestwood Farmers Supply Center, Crestwood, Ky.		
Crestwood 44% Dairy Concentrate	N. P. N. (Urea) 18.34%	22.5%
Crestwood 44% Dairy Concentrate	N. P. N. (Urea) 18.34%	22.0%
Crestwood 44% Dairy Concentrate	N. P. N. (Urea) 18.34%	22.1%
Crestwood 32% Special Dairy Concentrate	N. P. N. (Urea) 10.5%	12.2%
Crestwood 32% Cattle Supplement	Crude Fiber 8.0%	9.1%
Crestwood 36% Hog Balancer Medicated	Arsanilic Acid 0.0125%	0.006%
Crestwood Complete 16% Pig Ration Medicated	Arsanilic Acid 0.01%	0.006%
Darling & Co., Cincinnati, Ohio		
Darling's Mineral Mix	Salt 20.0%	22.2%
Dearborn Mills, Aurora, Indiana		
Dearborn 45% Cattle & Dairy Supplement	Calcium 1.9%	1.15%
Dearborn Dog Food	Crude Protein 26.0%	25.2%
Dearborn Dog Food	Crude Protein 26.0%	24.6%
Decatur Cotton Oil Co., Decatur, Alabama		
41% Cottonseed Meal	Crude Protein 41.0%	39.8%
	Crude Fiber 13.0%	15.0%
Deep Run Packing Co., Dublin, Pennsylvania		
Big Bet Cat Food	Crude Fat 2.0%	0.4%
W. C. Dicken, Mentor, Kentucky		
Sunny Grain Growing Mash Medicated	Nitrofurazone 0.0055%	0.0002%
Sunny Grain Pig & Sow Feed	Crude Fiber 6.0%	6.7%
Dixie Mills Co., East St. Louis, Missouri		
Dixie 40% Pig Grower Concentrate	Crude Protein 40.0%	39.0%
Duncan's Farm Service, Lawrenceburg, Kentucky		
Check-R-Mix Laying Mash	Crude Protein 18.0%	17.2%
The Early & Daniel Co., Cincinnati, Ohio		
Tuxedo Turkey Finisher 222 Medicated	4-Nitro 0.025%	0.0165%
Tuxedo Start, Grow & Develop Mash Medicated	Nitrofurazone 0.0055%	0.0037%
Tuxedo Breeder Mash Medicated	Arsanilic Acid 0.02%	0.0149%
Tuxedo Egg mash Medicated	Arsanilic Acid 0.02%	0.014%
Tuxedo 44% Dairy Supplement	Crude Protein 44.0%	43.1%
Tuxedo 44% Dairy Supplement	Crude Protein 44.0%	34.1%
Tuxedo 44% Dairy Supplement	Crude Protein 44.0%	42.9%
Tuxedo 44% Dairy Supplement	Crude Protein 44.0%	43.0%
Tuxedo 24% Coarse Dairy Feed	N. P. N. (Urea) 6.0%	9.2%
Tuxedo 32% Big A Steer Supplement	N. P. N. (Urea) 10.6%	14.6%
Tuxedo 32% Big A Steer Supplement	N. P. N. (Urea) 10.6%	12.0%
Tuxedo Wheat Middlings & Screenings	Crude Fiber 6.0%	7.6%
John W. Eshelman & Sons, Lancaster, Pennsylvania		
Red Rose Chick Starter Medicated	Crude Fiber 4.5%	5.3%
Eshelman Grain, Inc., Columbus, Ohio		
K-J 20% Laying Mash	Crude Fiber 8.5%	9.7%
Sunbeam Laying Mash	Crude Protein 20.0%	18.6%
Life Guard Special 24% Dairy Feed	Crude Protein 24.0%	19.6%
Life Guard Special 24% Dairy Feed	Crude Protein 24.0%	22.3%
52% Hi-Pro Cattle Supplement	Crude Protein 52.0%	50.2%

TABLE 2 SAMPLES CLASSIFIED AS "NOT PASSED"

MANUFACTURER, ADDRESS AND BRAND	GUARANTEED	FOUND
Fabro, Inc., Athens, Georgia		
Henny Pen Dog Food	Crude Fat 2.0%	7.68%
Henny Pen Dog Food	Crude Fat 2.0%	0.8%
Famous Feed Mills, Nashville, Tennessee		
Famous Hi-Calorie Chick Starter Medicated	Crude Fat 5.0%	4.4%
Famous 44% Dairy Supplement		Contained rice hulls
Golden Gain 40% Hog Supplement	Crude Protein 40.0%	36.3%
Golden Gain 40% Hog Supplement	Crude Protein 40.0%	38.4%
	Crude Fiber 7.0%	7.8%
Famous 40% Hog Supplement	Crude Protein 40.0%	39.2%
Famous 40% Hog Supplement	Crude Protein 40.0%	36.9%
Famous 40% Hog Supplement	Crude Protein 40.0%	37.8%
Famous 40% Hog Supplement	Crude Protein 40.0%	37.7%
Famous Pig & Hog Ration	Crude Fiber 6.0%	7.1%
Famous Formula One Sow Mixture Medicated	Crude Fiber 4.0%	4.9%
Farmers Elevators, Inc., Owensboro, Kentucky		
Feeders Friend 40% Hog Supplement Medicated	Crude Fiber 3.5%	6.4%
Feeders Friend 40% Hog Supplement Medicated	Crude Fiber 3.5%	6.1%
Feeders Friend 40% Hog Supplement Medicated	Arsanilic Acid 0.05%	0.0%
Feeders Friend 35% Hog Balancer	Crude Protein 35.0%	31.4%
	Crude Fiber 7.0%	7.8%
Feeders Friend Horse Feed	Crude Fiber 9.7%	10.7%
Farmers Elevator Co., Franklin, Kentucky		
12% Pork Builder	Crude Fiber 4.0%	7.5%
Farmers & Merchants Milling Co., Brooksville, Kentucky		
Wheat Mixed Feed & Screenings	Crude Fat 4.0%	3.3%
Farmers Milling Co., Somerset, Kentucky		
Spotlight 20% Starter-Grower All Mash	Crude Protein 20.0%	18.4%
	Crude Fiber 7.0%	7.6%
Spotlight 16% Dairy Feed		Contained oat hull feed
Spotlight 16% Dairy Feed	Crude Fat 3.0%	1.6%
Spotlight 16% Dairy Feed	Crude Fat 3.0%	1.6%
	Crude Fiber 10.0%	11.0%
	N. P. N. (Urea) 5.3%	7.2%
Farmers 20% Mixed Feed	Crude Protein 20.0%	18.3%
Farmers Hog Feed	Crude Fiber 8.0%	8.7%
Farmers Hog Feed	Crude Fiber 8.0%	11.2%
	Crude Fat 4.0%	3.3%
Farmers Hog Feed	Crude Fiber 8.0%	10.0%
Farmers Hog Feed	Crude Fiber 8.0%	9.0%
Farmers XXX Stock Feed	Crude Protein 12.5%	11.3%
Farmers XXX Stock Feed	Crude Protein 12.5%	11.6%
Wheat Brown Shorts	Crude Protein 15.0%	14.0%
Farmers Supply, Beaver Dam, Kentucky		
Farmers Check-R-Mix Laying All Mash SA	Crude Protein 16.0%	15.2%
Farmers Check-R-Mix Laying All Mash SA	Crude Protein 16.0%	14.7%
Farmers Union Mill, Versailles, Kentucky		
Mixed Feed	Crude Protein 13.0%	12.2%
Mixed Feed	Crude Protein 13.0%	11.9%
	Crude Fat 4.5%	3.5%

TABLE 2 SAMPLES CLASSIFIED AS "NOT PASSED"

MANUFACTURER, ADDRESS AND BRAND	GUARANTEED	FOUND
Ferncliff Feed & Grain Co., Louisville, Kentucky		
P.D.Q. 20% Laying Mash	Crude Protein 20.0%	18.9%
P.D.Q. Scratch Feed		Unground weed seeds
Ferncliff 24% Dairy Feed		Unground weed seeds
Ferncliff 24% Dairy Feed	N. P. N. (Urea) 7.86%	9.2%
Cracker Jack Dog Food	Crude Protein 25.0%	23.9%
Flambeau Milling Co., Phillips, Wisconsin		
Flambo Pulverized White Oats with Grain and Mixed Screenings	Crude Fat 4.5%	3.9%
	Crude Fiber 15.0%	15.8%
Flambo Pulverized White Oats with Grain and Mixed Screenings	Crude Fat 4.5%	3.6%
Pulverized Flambo Mixed Feed Oats (Containing Oat and Mixed Screenings)	Crude Fiber 15.0%	16.0%
Francis Wholesale Co., Prestonsburg, Kentucky		
Francis Pig & Sow Medicated	Crude Protein 16.0%	14.2%
Henry Fruechtenicht Co., Louisville, Kentucky		
Producer 20% Egg Mash	Crude Protein 20.0%	18.9%
Producer 44% Dairy Concentrate	N. P. N. (Urea) 18.34%	21.9%
Producer 44% Dairy Concentrate	N. P. N. (Urea) 18.34%	20.3%
Producer 44% Dairy Concentrate	N. P. N. (Urea) 18.34%	20.1%
Producer 44% Dairy Concentrate	N. P. N. (Urea) 18.34%	20.5%
Producer 44% Dairy Concentrate	N. P. N. (Urea) 18.34%	20.2%
Producer 44% Dairy Concentrate	Crude Protein 44.0%	41.7%
Producer 33% Dairy Concentrate	N. P. N. (Urea) 10.5%	12.3%
Producer 24% Dairy Feed	Crude Protein 24.0%	22.6%
Producer 24% Dairy Feed	Crude Protein 24.0%	22.4%
Producer 24% Dairy Feed	Crude Protein 24.0%	23.4%
Producer 16% Special Dairy Feed	Crude Fat 2.5%	1.8%
Producer 16% Special Dairy Feed	Crude Protein 16.0%	14.5%
Producer 44% Beef Concentrate	N. P. N. (Urea) 18.34%	20.2%
Producer 44% Beef Concentrate	N. P. N. (Urea) 18.34%	21.1%
Producer 40% Hog Supplement	Crude Protein 40.0%	38.4%
Producer 40% Hog Supplement	Crude Protein 40.0%	38.8%
Producer 40% Hog Supplement	Crude Protein 40.0%	38.0%
Producer 40% Hog Supplement	Crude Protein 40.0%	38.4%
Producer 40% Hog Supplement	Crude Protein 40.0%	38.5%
Producer 40% Hog Supplement	Crude Protein 40.0%	38.0%
Producer Pig Grower Medicated	Arsanilic Acid 0.01%	0.007%
Producer Pig Grower Medicated	Arsanilic Acid 0.01%	0.0066%
Producer Pig Grower Medicated	Arsanilic Acid 0.01%	0.0074%
Producer Dog Food	Crude Protein 26.0%	25.4%
Fuhrer - Ford Milling Co., Inc. Mt. Vernon, Ind.		
Wheat Shorts & Screenings	Crude Protein 16.0%	14.9%
Wheat Shorts & Screenings	Crude Protein 16.0%	15.2%
Wheat Shorts & Screenings	Crude Protein 16.0%	15.0%
Wheat Shorts & Screenings	Crude Protein 16.0%	15.2%
Wheat Shorts & Screenings	Crude Protein 16.0%	14.7%
Wheat Shorts & Screenings	Crude Protein 16.0%	14.0%
Wheat Bran	Crude Fat 3.5%	2.9%
Wheat Bran	Crude Fat 3.5%	2.7%
Wheat Bran	Crude Fat 3.5%	2.9%
Wheat Bran	Crude Fat 3.5%	2.8%
Wheat Bran	Crude Fat 3.5%	2.9%
Wheat Bran	Crude Fat 3.5%	2.9%
Wheat Bran	Crude Fat 3.5%	2.8%
Wheat Bran	Crude Fat 3.5%	2.6%
Wheat Bran	Crude Fat 3.5%	2.7%

TABLE 2 SAMPLES CLASSIFIED AS "NOT PASSED"

MANUFACTURER, ADDRESS AND BRAND	GUARANTEED	FOUND
Ft. Negley Mills, Nashville, Tennessee Luxurt 40% Hog Supplement	Crude Protein 40.0%	38.6%
Garrard Mills, Lancaster, Kentucky Garrard 24% Dairy Feed		Unground weed seeds
Garrard 24% Dairy Feed	Crude Fat 2.5%	1.8%
Moore's Special 16% Dairy Feed		Soybean hulls
Big G Horse & Mule Feed	Crude Protein 10.0%	8.6%
Big G Horse & Mule Feed	Crude Protein 10.0%	9.0%
Big G Horse & Mule Feed	Crude Protein 10.0%	8.3%
Big G Horse & Mule Feed	Crude Protein 10.0%	9.0%
Moore's 40% Hog Balancer Medicated	Arsanilic Acid 0.04%	0.0091%
Moore's 40% Hog Balancer Medicated	Arsanilic Acid 0.04%	0.0122%
Moore's 40% Hog Balancer Medicated	Arsanilic Acid 0.04%	0.0112%
Moore's 40% Hog Balancer Medicated	Crude Protein 40.0%	38.7%
Moore's Pig & Sow Feed Medicated	Crude Fiber 6.0%	8.7%
Glen Lilly Farm Feed	Crude Protein 12.5%	11.4%
Glen Lilly Farm Feed	Crude Protein 12.5%	8.5%
		Mixed Screenings
Ground Barley	Fat 2.5%	1.8%
J. I. Gates Milling Co., Columbus, Ohio Economy 22% Brewers Molasses	Crude Fat 5.0%	4.2%
General Distributors, South Ft. Mitchell, Ky. General Feeds Heavy Milker 16% Dairy Feed	Crude Protein 16.0%	13.5%
General Feeds Heavy Milker 16% Dairy Feed	Crude Protein 16.0%	14.5%
General Feeds - Made Rite Hog Fattener	Crude Protein 14.0%	12.5%
General Mills, Inc., Minneapolis, Minnesota Larro Special L Surepoult	Crude Fiber 5.5%	6.6%
Special Suremilk	Crude Protein 50.0%	48.0%
	Crude Fiber 5.5%	6.8%
Special Suremilk	Crude Protein 50.0%	48.8%
	Crude Fiber 5.5%	7.6%
Special Suremilk	Crude Protein 50.0%	43.4%
	Crude Fiber 5.5%	6.3%
Special Suremilk	Crude Protein 50.0%	46.7%
	Crude Fiber 5.5%	7.1%
Gilster Milling Co., Chester, Illinois Gilster's Wheat Bran	Crude Fat 3.75%	2.9%
Gilster's Wheat Bran	Crude Fat 3.75%	2.2%
Gwinn Brothers & Co., Huntington, W. Va. Milk Producer 24% Dairy Feed	Crude Protein 24.0%	23.3%
Milk Producer 24% Dairy Feed	Crude Protein 24.0%	22.7%
18% Pig & Hog Feed	Crude Fiber 6.0%	6.6%
Harvest Brand, Inc., Pittsburg, Kansas Stockade 39% Protein Block	Crude Protein 39.0%	37.2%
	Salt 14.0%	16.7%
Hales & Hunter Co., Chicago, Illinois Red Comb Egg Mash Medicated	Arsanilic Acid 0.02%	0.006%
Pioneer Hog Balancer	Crude Protein 36.0%	34.3%
	Crude Fiber 6.0%	7.0%
Pioneer Hog Balancer	Crude Protein 36.0%	34.9%
	Arsanilic Acid 0.05%	0.0236%
Hardin County Milling Co., Elizabethtown, Ky. Valley Creek 16% Dairy Feed	N.P.N. (Urea) 1.0%	3.1%
Valley Creek 16% Dairy Feed	N.P.N. (Urea) 1.0%	2.8%

TABLE 2 SAMPLES CLASSIFIED AS "NOT PASSED"

MANUFACTURER, ADDRESS AND BRAND	GUARANTEED	FOUND
Hardy Brothers Mill, Walton, Kentucky		
Hardy's Special Calf Feed	Crude Protein 13.0%	12.2%
Hardy's Special Calf Feed	Crude Protein 13.0%	11.9%
Harpeth Mills, Nashville, Tennessee		
Peerless Laying Mash	Crude Protein 20.0%	18.4%
Peerless 16% Dairy Feed	Crude Fat 3.0%	1.6%
	Crude Fiber 15.0%	17.2%
The P. H. Harsha Milling Co., Portsmouth, Ohio		
Harsha's Dixie-Sweet 16% Dairy Feed	Crude Fat 3.0%	1.5%
T. J. Haycraft's Sales & Service, Leitchfield, Kentucky		
Haycraft's 21% Chick Starter Medicated Scratch Feed	3-Nitro-4 0.005%	0.0005% Unground weed seeds
Hay Market Mills, Nashville, Tennessee		
Tip-Top Hominy Feed	Crude Fiber 5.0%	7.3%
Haydon Mill & Grain Co., Springfield, Kentucky		
Magic Growing Mash, Medicated	Crude Protein 18.0%	17.3%
Magic Broiler Starter, Medicated	3-Nitro-4 0.005%	0.0001%
Magic Wheat Shorts & Screenings	Crude Protein 15.0%	12.0%
Dr. Heinz Co., Inc., Washington C. H., Ohio		
Heinz Nu-Way 40% Hog Supplement	Crude Protein 40.0%	39.0%
Hodgenville Roller Mill, Hodgenville, Kentucky		
Lincoln Wheat Mill Run	Crude Fat 4.0%	3.4%
Lincoln Wheat Mill Run	Crude Fat 4.0%	3.3%
	Crude Protein 14.0%	12.9%
Home Milling Co., Greenville, Kentucky		
Happy Home 24% Dairy Feed		Contained weed seeds
Happy Home 24% Dairy Feed	Crude Fat 4.0%	3.3%
		Contained rice hulls
Happy Home 24% Dairy Feed	Crude Fat 4.0%	2.9%
Happy Home 24% Dairy Feed	Crude Fiber 8.0%	10.4%
Happy Home 24% Dairy Feed	Crude Protein 24.0%	22.4%
	Crude Fat 4.0%	2.8%
Happy Home 24% Dairy Feed	Crude Fat 4.0%	3.1%
	Crude Fiber 8.0%	9.5%
Happy Home 16% Sweet Dairy Feed	Crude Fat 2.5%	1.8%
		Contained oat hulls
Happy Home 16% Sweet Dairy Feed	Crude Fat 2.5%	1.7%
		Contained oat hulls
Happy Home 16% Sweet Dairy Feed	Crude Fat 2.5%	1.9%
Happy Home 16% Sweet Dairy Feed		Contained rice hulls
Happy Home 16% Sweet Dairy Feed		Contained rice hulls
Happy Home 16% Sweet Dairy Feed	Crude Protein 16.0%	14.5%
	Crude Fat 2.5%	1.9%
Happy Home 16% Sweet Dairy Feed	Crude Fat 2.5%	1.9%
		Unground weed seeds
Happy Home 16% Sweet Dairy Feed		Unground weed seeds
Farm-Wa Dairy Feed 16%	Crude Fat 4.0%	2.5%
Farm-Wa Dairy Feed 16%	Crude Fat 4.0%	2.6%
Farm-Wa Dairy Feed 16%	Crude Fiber 12.0%	12.9%
		Unground weed seeds

TABLE 2 SAMPLES CLASSIFIED AS "NOT PASSED"

MANUFACTURER, ADDRESS AND BRAND	GUARANTEED	FOUND
Champion 40% Hog Supplement	Crude Protein 40.0%	39.1%
Champion 40% Hog Supplement	Crude Protein 40.0%	37.6%
Champion 40% Hog Supplement	Crude Protein 40.0%	36.6%
Igleheart Brothers, Evansville, Indiana Wheat Bran	Crude Fat 3.5%	2.9%
J. F. Imbs Milling Co., Belleville, Illinois Charm Wheat Bran	Crude Fat 3.5%	2.5%
Charm Wheat Bran	Crude Fat 3.5%	2.8%
Charm Wheat Bran	Crude Fat 3.5%	2.9%
Keller Hay & Grain Co., Newport, Kentucky Big K Pig & Sow Ration	Crude Protein 16.0%	15.4%
Big K Pig & Sow Ration	Crude Protein 16.0%	15.4%
Spencer Kellogg & Sons, Kansas City, Missouri Professional Rumen Atomix	Crude Protein 44.0%	43.3%
Professional Taffy 22% Cattle Supplement	Crude Fiber 9.0%	11.3%
Professional Taffy 22% Cattle Supplement	Crude Fiber 9.0%	11.4%
Professional Pig Mama (Pig & Sow Feed) Medicated	3-Nitro-4 0.005%	0.0023%
Professional Grower A Medicated	Arsanilic Acid 0.01%	0.0029%
Professional Grower A Medicated	Arsanilic Acid 0.01%	0.0028%
Keynes Brothers, Logan, Ohio Check Mark 24% Dairy Feed	Crude Protein 24.0%	22.1%
Check Mark 24% Dairy Feed	Crude Protein 24.0%	22.7%
Check Mark 24% Dairy Feed	Crude Fat 2.5%	1.7%
Check Mark 16% Dairy Feed	Crude Protein 16.0%	14.0%
	Crude Fat 2.5%	1.1%
Check Mark 16% Dairy Feed	Crude Protein 16.0%	14.1%
Check Mark 16% Dairy Feed	Crude Protein 16.0%	14.8%
Check Mark 16% Dairy Feed	Crude Protein 16.0%	14.4%
The Klarer Co., Louisville, Kentucky Klarer 60% Digester Tankage	Crude Protein 60.0%	58.0%
Lake County Oil Mill, Tiptonville, Tennessee Solvent Extracted 41% Cottonseed Meal	Crude Protein 41.0%	40.1%
Solvent Extracted 41% Cottonseed Meal	Crude Protein 41.0%	38.8%
Solvent Extracted 41% Cottonseed Meal	Crude Protein 41.0%	37.6%
Edmond J. Lang, New York, N. Y. Steamed Bone Meal	Crude Fat 2.0%	0.4%
Lee Dog Food Co., LaGrange, Kentucky Cliffs Horse Meat 10% Soya Grits	Crude Fat 3.0%	12.5%
Lewisburg Roller Mills, Lewisburg, Kentucky Economy 16% Dairy Feed		Unground weed seeds
Economy 16% Dairy Feed	Crude Fat 2.5%	1.4%
Economy 16% Dairy Feed	N.P.N. (Urea) 5.24%	7.2%
Pay Master Economy Hog Ration	Crude Protein 14.0%	13.3%
Lexington Roller Mills, Lexington, Kentucky Thoroughbred Scratch Feed		Unground weed seeds
Bossie Stock Feed		Unground weed seeds
Derby Dog & Puppy Crumbles	Crude Protein 24.0%	23.2%
Thoroughbred Wheat Shorts & Screenings	Crude Protein 15.0%	14.1%
Life Guard Feeds, Columbus, Ohio K-J 20% Laying Mash	Crude Fiber 8.5%	9.4%
Lilly Brothers Seed Co., Hopkinsville, Kentucky Hep All Mash Laying Ration	Crude Protein 16.0%	14.5%
Lipscomb Farm Supply, Walton, Kentucky Lipscomb's 16% Dairy Feed	Crude Protein 16.0%	15.3%

TABLE 2 SAMPLES CLASSIFIED AS "NOT PASSED"

MANUFACTURER, ADDRESS AND BRAND	GUARANTEED	FOUND
Lowe's Feed & Hatchery, Bowling Green, Kentucky Milk-Flo 16% Dairy Feed		Unground weed seeds
Milk-Flo 16% Dairy Feed	Crude Protein 16.0% Crude Fiber 9.0%	15.3% 10.4%
Meat Maker 18% Hog Ration Lowe's Sweet Feed Mix	Crude Protein 18.0% Crude Protein 12.5%	16.9% 11.9%
Lowe's Sweet Feed Mix Lowe's Sweet Feed Mix	Crude Protein 12.5%	Unground weed seeds 10.0%
Lowe's Sweet Feed Mix		Unground weed seeds Unground weed seeds
Markin Feed Co., Ironton, Ohio Markin 16% Milk Maker	Crude Fat 2.5% Crude Fiber 15.0%	1.9% 16.5%
Mayfield Milling Co., Mayfield, Kentucky Big H 37% Hep Plus Poultry Mixing Concentrate Medicated	Furazolidone 0.01375%	0.0064%
Big H Hog Supplement	Crude Protein 40.0%	39.0%
Big H 35% Pig Popper Supplement	Arsanilic Acid 0.05%	0.0375%
Big HNF Brood Sow Pellets, Medicated	Crude Fiber 8.0%	8.7%
McCauley Brothers Seed Co., Versailles, Kentucky Pride of Woodford 16% Dairy	Crude Fat 2.5%	1.8%
McGahan Feed Co., Paintsville, Kentucky Pig & Sow Feed	Crude Protein 18.0%	16.8%
Corn & Cob Meal	Crude Protein 8.7%	7.5%
McKnight - Keaton Grocery Co., Sikeston, Missouri Radio Egg Pellets	Crude Protein 20.0%	18.1%
McMillen Feed Mills, Ft. Wayne, Indiana Master Mix 35% Hog Concentrate	Salt 1.8%	2.68%
Meadows Feed & Building Supply, Clay City, Ky. Meadows Check-R-Mix 16% Dairy S	Crude Protein 16.0%	13.8%
Meadows Check-R-Mix Hog Fattener	Crude Protein 14.0%	12.9%
Metzger Brothers, Paducah, Kentucky Tankage with Bone	Crude Protein 43.0%	41.5%
Tankage with Bone	Crude Protein 43.0%	42.2%
Tankage with Bone	Crude Fiber 2.0%	2.7%
Middlesboro Milling Co., Middlesboro, Kentucky Premium Scratch Feed		Unground weed seeds
Midget Mill, Somerset, Kentucky White Rose 24% Dairy Feed	Crude Fat 3.0%	2.0%
White Rose 24% Dairy Feed	Crude Protein 24.0%	21.9%
White Rose 16% Dairy Feed	Crude Fat 3.0%	1.5%
White Rose 16% Dairy Feed	Crude Fat 3.0%	2.1%
White Rose 16% Dairy Feed	Crude Fat 3.0%	2.4%
S. C. Mighton, Bedford, Ohio Doggie Dinner Dog Food	Crude Fat 2.0%	1.0%
Miller Milling Service, Bowling Green, Kentucky Alfalfa Meal	Crude Protein 13.0%	12.3%
Milliken Sweet Feed Mill, Franklin, Kentucky Milliken 36% Hog Concentrate	Crude Fat 13.5%	11.8%

TABLE 2 SAMPLES CLASSIFIED AS "NOT PASSED"

MANUFACTURER, ADDRESS AND BRAND	GUARANTEED	FOUND
Mineral Products Co., Indianapolis, Indiana Farmers Choice Mineral	Salt 9.0%	13.3%
Monarch Milling Co., Mt. Sterling, Kentucky Monarch Pig Grower	Crude Fat 3.5%	2.9%
Mixed Feed with Screenings Monarch Pig Grower	Crude Fat 3.0%	2.2%
Monarch Special 16% Dairy		Unground weed seeds
Monarch Special 16% Dairy		Unground weed seeds
Monarch Special 16% Dairy		Unground weed seeds
Morgantown Feed Mill, Morgantown, Kentucky Flavo 16% Dairy Feed	Crude Protein 16.0%	15.2%
Flavo 16% Dairy Feed	Crude Protein 16.0%	14.7%
Myers & Clark Milling Co., Ashland, Kentucky Ideal 17% Hog & Pig Feed	Crude Protein 17.0%	16.0%
Nall Brothers Feed Mill, Vine Grove, Kentucky Nall's 16% Dairy Feed	Crude Protein 16.0%	14.7%
National Alfalfa Dehydrating & Milling Co LaMar, Colorado National Dehydrated Alfalfa Meal	Crude Protein 17.0%	16.4%
National Distillers Products Co., New York, N. Y. Corn Distillers Dried Grains	Crude Fat 7.0%	6.2%
National Oats Co., East St. Louis, Illinois Corno Egg Mash	Crude Protein 20.0%	19.4%
Corno 42% Dairy Concentrate	Crude Protein 42.0%	40.7%
Corno 42% Dairy Concentrate	Crude Protein 42.0%	41.3%
Corno Hog Balancer	Salt 2.25%	3.4%
Corno Pig Supplement	Calcium 3.5%	2.75%
The New Era Milling Co., Arkansas, Kansas Polar Bear Wheat Shorts & Screenings	Crude Fiber 6.0%	6.8%
The North American Trading & Import Co., Philadelphia, Pennsylvania Natico Dry Corn Molasses Product	Invert Sugar 45.0%	39.0%
Charles Nunn & Sons Milling Co., Evansville, Ind. Nunn Better 40% Hog Supplement	Calcium 4.0%	3.36%
Nunn Better 35% Pig & Sow Supplement	Calcium 4.25%	3.48%
Nunn Better Shorts & Screenings	Crude Protein 15.0%	14.2%
	Crude Fiber 6.0%	7.0%
Nutrena Mills, Inc., Minneapolis, Minnesota Nutrena 40% Hog Concentrate	Crude Protein 40.0%	39.2%
Ohio Valley Soybean Coop., Henderson, Kentucky Cardinal 44% Solvent Extracted Soybean Meal	Crude Fiber 7.0%	8.5%
Orleans Dog Candy Co., Chicago, Illinois Lolli-Pups	Crude Fat 2.5%	1.7%
Owensboro Grain Co., Owensboro, Kentucky Agroco Solvent Extracted Soybean Meal	Crude Protein 44.0%	43.4%
Argoco Solvent Extracted Soybean Meal	Crude Fiber 7.0%	7.8%
Argoco Solvent Extracted Soybean Meal	Crude Fiber 7.0%	7.7%
Owensboro Milling Co., Owensboro, Kentucky Tru-Test Dog Food	Crude Protein 26.0%	25.3%
Pan American Mills, Bowling Green, Kentucky Bell Ringer 16% Dairy Feed		Unground weed seeds
Bell Ringer 16% Dairy Feed		Unground weed seeds
Booster 40% Hog Supplement		Arsanilic Acid
Green Valley 35% Hog Supplement		Arsanilic Acid

TABLE 2 SAMPLES CLASSIFIED AS "NOT PASSED"

MANUFACTURER, ADDRESS AND BRAND	GUARANTEED	FOUND
Green Valley 35% Hog Supplement	Crude Fiber 7.0%	7.6%
Sun-Ray Horse & Mule Feed	Crude Protein 10.0%	8.9
Pierce & Williams, Hopkinsville, Kentucky		
Pierce & William's Check-R-Mix Hog		
Finisher No. 1 (A) 3-N	3-Nitro-4 0.004	0.0023%
Pierce & William's Check-R-Mix Hog		
Finisher No. 1 (A) 3-N	3-Nitro-4 0.004	0.0008%
The Pillsbury Co., Minneapolis, Minnesota		
Pillsbury's Best Starter & Grower Medicated	Furazolidone 0.0011	0.0009%
Pillsbury's Best 32% Dairy Supplement	Crude Protein 32.0%	31.1%
Pillsbury's Champion 16% Dairy Feed		Rice Mill
		Feed
Pillsbury's Best Beef Cattle Concentrate	Crude Protein 32.0%	30.6%
Pillsbury's Best Pig Starter, Medicated	3-Nitro-4 0.0025%	0.0019
Pillsbury's Best Canine Crunch	Crude Fat 7.0%	6.3%
Pillsbury's Best Corn Distiller's Dried Grains	Crude Fiber 14.0%	14.6%
Princeton Mills, Princeton, Kentucky		
Check-R-Mix 16% Dairy Feed	Crude Protein 16%	14.1%
Farm-Way 40% Sow & Hog Supplement	Crude Protein 40.0%	39.3%
Chowmix Sow & Pig Feed	Crude Protein 16.0%	15.0%
Quaker Oats Co., Chicago, Illinois		
Ful-O-Pep Calf Ration L	Crude Protein 20.0%	19.0%
Ful-O-Pep Milking 40% M	Crude Protein 40.0%	39.0%
Puss'n Boots Cat Food	Crude Protein 12.0%	11.1%
Ralston Purina Co., St. Louis, Missouri		
Purina Chick Growena Zo Medicated	Crude Protein 17.0%	15.1%
Purina Layena Complete Ration	Crude Protein 16.0%	15.2%
Purina Cage Layena Complete Ration	Crude Protein 17.0%	15.7%
Purina Cage Chowder	Phosphorus 2.0%	1.43%
Purina Cow Chow Concentrate 50%	N. P. N. (Urea) 26.0%	29.0%
Purina Cow Chow Concentrate 50%	Crude Protein 50.0%	46.8%
Purina Cow Chow Concentrate 50%	N. P. N. (Urea) 26.0%	32.5%
	Calcium 4.0%	1.15%
	Salt 5.0%	0.77%
Purina Cow Chow Concentrate 32%	N. P. N. (Urea) 8.75%	10.8%
Purina Steer Fattena 32%	Crude Protein 32.0%	30.9%
Purina 40% Hog Chow Supplement	Crude Protein 40.0%	39.0%
Purina 40% Hog Chow Supplement	Salt 3.0%	3.7%
Purina 40% Hog Chow 3 NAB Medicated	3-Nitro-4 0.022	0.015%
Purina Pork Chow	Crude Protein 35.0%	33.9%
Purina Sow Chow	Crude Protein 32.0%	30.9%
Purina Pig Startena Medicated	3-Nitro-4 0.005%	0.0037%
Purina Pig Growena Medicated	3-Nitro-4 0.0025%	0.0018%
Soybean Hulls		Unground
		weed seeds
Randolph Milling Co., Bandana, Kentucky		
Ra-Mi-Co. 20% Egg Mash	Crude Protein 20.0%	18.9%
Ra-Mi-Co. 16% Dairy Feed	Crude Protein 16.0%	15.2%
Reelfoot Alfalfa Mill, Tiptonville, Tennessee		
17% Alfalfa Meal Dehydrated	Crude Protein 17.0%	16.1%
17% Alfalfa Meal Dehydrated	Crude Protein 17.0%	14.7%
17% Alfalfa Meal Dehydrated	Crude Protein 17.0%	15.0%
	Crude Fiber 27.0%	28.4%
Robbins Brothers, Auburn, Kentucky		
Hominy Feed	Crude Protein 10.0%	8.8%
	Crude Fat 7.0%	5.6%
Hominy Feed	Crude Protein 10.0%	8.4%
	Crude Fat 7.0%	3.4%
Hominy Feed	Crude Protein 10.0%	7.7%

TABLE 2 SAMPLES CLASSIFIED AS "NOT PASSED"

MANUFACTURER, ADDRESS AND BRAND	GUARANTEED	FOUND
Hominy Feed	Crude Fat 7.0%	4.7%
	Crude Protein 10.0%	8.6%
	Crude Fat 7.0%	5.9%
	Crude Protein 10.0%	8.1%
Hominy Feed Robinson Milling Co., Inc., Somerset, Kentucky Green Valley 24% Dairy Feed	Crude Protein 24.0%	21.5%
		Contained Mixed Screenings
Green Valley 24% Dairy Feed	Crude Protein 24.0%	19.4%
		Contained Mixed Screenings
Happy Home 16% Sweet Dairy	N. P. N. (Urea) 5.24%	6.7%
	Crude Fat 3.0%	2.3%
Happy Home 16% Sweet Dairy	N. P. N. (Urea) 5.24%	7.4%
Happy Home 16% Sweet Dairy	N. P. N. (Urea) 5.24%	6.5%
		Contained Mixed Screenings
Happy Home 16% Sweet Dairy	Crude Fat 3.0%	2.3%
		Contained Mixed Screenings
Happy Home 16% Sweet Dairy	Crude Fat 3.0%	2.4%
Happy Home 16% Sweet Dairy	Crude Protein 16.0%	14.5%
Sun Ray 40% Booster Hog Supplement Medicated	Crude Fiber 7.0%	8.7%
Sun Ray 40% Booster Hog Supplement	Arsanilic Acid 0.05%	0.015%
Rogers Feed Store, Corinth, Kentucky H-M 20% Dairy Feed	N. P. N. (Urea) 5.7%	8.4%
Russelville Feed Co., Russellville, Kentucky Burchett's 20% Laying Mash Medicated	Crude Fiber 5.5%	11.1%
Burchett's 50% Dairy Mixing Supplement	Crude Protein 50.0%	48.3%
	Crude Fiber 7.0%	8.6%
	Crude Protein 16.0%	11.9%
	Crude Protein 16.0%	11.4%
Burchett's 16% Dairy Feed		
Burchett's 16% Dairy Feed		
Burchett's 14% Sweet Dairy Feed (To be used with high protein Legume pasture, hay, or ensilage.)	N. P. N. (Urea) 3.28%	4.9%
Burchett's 14% Sweet Dairy Feed (To be used with high protein Legume pasture, hay, or ensilage.)		
Burchett's 40% Hog Supplement Medicated	Crude Fiber 7.0%	7.8%
		Unground weed seeds
Sandusky Brothers, Harrodsburg, Kentucky Winner Scratch Feed	Crude Protein 9.5%	8.5%
Winner Scratch Feed	Crude Protein 9.5%	8.8%
		Unground weed seeds
Cracked Corn and Wheat	Crude Protein 9.5%	8.2%
Cracked Corn and Wheat	Crude Protein 9.5%	8.6%
Corn Feed Meal	Crude Protein 8.0%	6.6%
	Crude Fat 3.75%	2.3%
The Scott County Milling Co., Sikeston, Missouri Gristo Poultry Mixing Concentrate	Crude Protein 34.0%	32.3%
Gristo Wheat Shorts & Screenings	Crude Protein 15.5%	14.7%
Southern Rendering Co., Shelbyville, Tennessee Southern Brand 60% Mixture Meat & Bone Meal, Hydrolyzed Poultry Feathers	Crude Protein 60.0%	53.6%

TABLE 2 SAMPLES CLASSIFIED AS "NOT PASSED"

MANUFACTURER, ADDRESS AND BRAND	GUARANTEED	FOUND
Southern States Glasgow Coop., Glasgow, Kentucky		
Coop. Pig Developer Medicated	Arsanilic Acid 0.005%	0.0025%
Coop. Pig Developer Medicated	Arsanilic Acid 0.005%	0.008%
Coop. Pig Developer Medicated	Arsanilic Acid 0.005%	0.01%
Southern States Leitchfield Coop., Leitchfield, Ky.		
20% Economy Laying Mash Medicated	Arsanilic Acid 0.015%	0.0067%
20% Economy Laying Mash Medicated	Arsanilic Acid 0.015%	0.0067%
20% Economy Laying Mash Medicated	Arsanilic Acid 0.015%	0.0067%
Southern States Hopkinsville Coop., Hopkinsville, Kentucky		
15% Pork Maker		Unground weed seeds
15% Pork Maker	Crude Protein 15.0%	10.8%
15% Pork Maker	Crude Fiber 3.0%	4.3%
Ground Barley	Crude Protein 12.0%	9.2%
Ground Barley	Crude Protein 12.0%	10.0%
Ground Barley	Crude Protein 12.0%	8.3%
Southland Cotton Oil Co., Shreveport, La.		
Sampson 41% Cottonseed Meal	Crude Fiber 14.0%	14.7%
		Not Registered
Woodford Spears & Son, Paris, Kentucky		
Bourbon 18% Dairy Feed	Crude Protein 18.0%	17.4%
Bourbon 18% Dairy Feed	Crude Protein 18.0%	16.5%
Spen-Well Feed Co., Winchester, Kentucky		
Newco Egg All Mash	Crude Fat 4.25%	2.7%
Newco Egg All Mash	Crude Fat 4.25%	2.7%
Newco Feeds 24% Dairy	Crude Protein 24.0%	20.2%
Newco Feeds 24% Dairy	Crude Fat 2.5%	1.8%
Newco Feeds 24% Dairy	Crude Fat 2.5%	1.9%
Newco Feeds 16% Dairy Feed	Crude Protein 16.0%	15.0%
Newco 40% Hog Supplement	Crude Protein 40.0%	35.0%
Newco 40% Hog Supplement	Crude Protein 40.0%	37.6%
A. E. Staley Manufacturing Co., Decatur, Illinois		
Staley's 44% Solvent Extracted Soybean Meal	Crude Fiber 7.0%	7.6%
Staley's 44% Solvent Extracted Soybean Meal	Crude Fiber 7.0%	7.8%
Staley's 44% Solvent Extracted Soybean Meal	Crude Fiber 7.0%	8.0%
Stewart's Feed Mill, Flat Lick, Kentucky		
Stewart's Best Hog Fattener	Crude Fiber 3.0%	3.9%
Sturgis Milling Co., Sturgis, Kentucky		
Neva Fail 18% All Mash Laying Ration	Crude Protein 18.0%	17.2%
Neva Fail Vim 21% Egg Mash	Crude Fiber 6.5%	7.2%
Hoppy's 18% Pig Starter Medicated	Arsanilic Acid 0.01%	0.0023%
Hoppy's 18% Pig Starter Medicated	Arsanilic Acid 0.01%	0.0197%
Hoppy's 40% Hog Supplement	Crude Protein 40.0%	38.2%
Hoppy's 40% Hog Supplement	Crude Protein 40.0%	39.0%
Hoppy's 40% Hog Supplement	Crude Protein 40.0%	39.4%
Sun-Ray Feed Mills, Bowling Green, Kentucky		
Sun-Ray 20% Laying & Breeder Mash	Crude Fat 4.0%	3.2%
Sun-Ray 24% Sweet Dairy Feed	Crude Protein 24.0%	23.3%
Sun-Ray 24% Sweet Dairy Feed	Crude Protein 24.0%	23.4%
Sun-Ray 24% Sweet Dairy Feed	Crude Fat 4.0%	2.8%
Sun-Ray 24% Sweet Dairy Feed	Crude Fat 4.0%	2.6%
Sun-Ray 24% Sweet Dairy Feed	Crude Fat 4.0%	2.7%
Green Valley 16% Dairy Feed		Unground weed seeds
Booster 18% Pig & Hog Feed	Crude Protein 18.0%	17.3%
Supreme Mills, Glasgow, Kentucky		
Supreme 32% Poultry Supplement		Arsanilic Acid
Supreme 20% Starter & Grower	Crude Protein 20.0%	19.2%

TABLE 2 SAMPLES CLASSIFIED AS "NOT PASSED"

MANUFACTURER, ADDRESS AND BRAND	GUARANTEED	FOUND
Supreme 20% Laying Mash Medicated	Crude Fiber 3.5%	4.7%
Supreme 45% Dairy Concentrate	Crude Protein 45.0%	42.5%
Supreme 45% Dairy Concentrate	Crude Protein 45.0%	43.3%
Premo 24% Dairy Feed	N. P. N. (Urea) 6.55%	8.6%
Premo 24% Dairy Feed	Crude Protein 24.0%	23.0%
Premo 24% Dairy Feed	Crude Protein 24.0%	23.3%
Premo 24% Dairy Feed	Crude Protein 24.0%	23.1%
Supreme Special 20% Dairy Feed	Crude Protein 20.0%	18.0%
Supreme Special 16% Dairy Feed		Unground weed seeds
Premo 20% Calf Developer Medicated	Crude Fat 3.0%	2.2%
Premo 40% Hog Supplement	Crude Protein 40.0%	38.7%
Premo 40% Hog Supplement	Crude Protein 40.0%	38.8%
Premo 40% Hog Supplement	Crude Protein 40.0%	39.0%
Premo 40% Hog Supplement	Crude Protein 40.0%	37.0%
Premo 40% Hog Supplement	Crude Fiber 7.0%	7.0%
Premo 40% Hog Supplement	Crude Protein 40.0%	38.1%
Premo 40% Hog Supplement	Crude Fiber 7.0%	9.4%
Premo 40% Hog Supplement	Crude Protein 40.0%	38.8%
Premo 40% Hog Supplement	Crude Fiber 7.0%	8.8%
Premo 40% Hog Supplement	Crude Protein 40.0%	38.1%
Premo 40% Hog Supplement	Crude Fiber 7.0%	8.0%
Premo 40% Hog Supplement	Crude Protein 40.0%	37.9%
Premo 40% Hog Supplement	Crude Fiber 7.0%	8.4%
Premo 40% Hog Supplement	Crude Protein 40.0%	38.6%
Premo 40% Hog Supplement	Arsanilic Acid 0.05%	0.0137%
Premo 40% Hog Supplement	Arsanilic Acid 0.05%	0.028%
Premo 40% Hog Supplement		Arsanilic Acid
Drummer Boy 40% Hog Supplement	Crude Protein 40.0%	39.4%
Drummer Boy 40% Hog Supplement	Crude Protein 40.0%	37.7%
Drummer Boy 40% Hog Supplement	Crude Protein 40.0%	37.8%
Drummer Boy 40% Hog Supplement	Crude Protein 40.0%	38.3%
Supreme 17 1/2 Pig & Hog Feed	Arsanilic Acid 0.01%	0.0078%
D. B. Sutherland & Sons, Bloomfield, Kentucky		22.7%
Kentucky Star Special 24% Dairy Feed	Crude Protein 24.0%	Unground weed seeds
Kentucky Star Special 24% Dairy Feed	Crude Protein 24.0%	
Kentucky Star Special 16% Dairy Feed	Crude Protein 16.0%	13.8%
Kentucky Star Farm Feed	Crude Protein 16.0%	13.6%
Kentucky Star Farm Feed	Crude Protein 16.0%	14.4%
Kentucky Star 15% Hog Feed	Crude Fat 3.5%	2.9%
Kentucky Star 15% Hog Feed	Crude Protein 15.0%	14.2%
Kentucky Star 15% Hog Feed	Crude Protein 15.0%	12.0%
Swift & Co., Chicago, Illinois		
Swift's Golden Supplement Block	N. P. N. (Urea) 12.0%	14.7%
T & H Feed Service, Lebanon, Kentucky		
Marco 16% Dairy Feed	Crude Protein 16.0%	15.4%
The Thorobred Co., Inc., Waynesville, Ohio		
Thorobred Chicken Parts Dog Food	Crude Fat 6.0%	13.0%
Thurmonds Coal & Feed Co., Murray, Kentucky		
Thurmond's Hog Developer	Crude Protein 15.0%	14.0%
Todd County Grain Co., Elkton, Kentucky		
Ground Oats		Unground weed seeds
Ground Barley	Crude Protein 11.0%	8.4%
Ground Barley	Crude Protein 11.0%	8.2%

TABLE 2 SAMPLES CLASSIFIED AS "NOT PASSED"

MANUFACTURER, ADDRESS AND BRAND	GUARANTEED	FOUND
Trader's Oil Mill Co., Fort Worth, Texas 41% Cottonseed Meal	Crude Protein 41.0%	40.3%
Trenton Cotton Oil Co., Trenton, Tennessee Trenton 41% Cottonseed Meal, Prime Quality	Crude Protein 41.0%	38.4%
Trenton Milling Co., Trenton, Illinois Easter Lily Wheat Shorts & Screenings	Crude Protein 16.0%	14.5%
Walters & Thompson, Shelbyville, Kentucky Hominy Feed	Crude Protein 9.0%	8.4%
Warner's Farm Supply, Somerset, Kentucky Check-R- Mix Pig Starter (SA) 3AB Medicated	Arsanilic Acid 0.007%	0.0016%
Weisenberger Mills, Midway, Kentucky Mixed Feed	Crude Protein 14.0%	13.1%
Gardener White, Princeton, Kentucky Home Town 20% Laying Mash	Crude Protein 20.0%	19.4%
Martha White Mills of W. Va., Huntington, W. Va. Fortune Hominy Feed	Crude Fat 5.0%	4.2%
The Whitewater Flour Mill Co., Whitewater, Kansas Wheat Shorts & Screenings	Crude Fiber 6.0%	6.7%
Williamstown Roller Mills, Williamstown, Ky. Our Own 20% Egg Mash	Crude Fat 3.5%	2.6%
Our Own 20% Egg Mash	Crude Fat 3.5%	2.4%
Standard Mix Dairy 16%	Crude Protein 16.0%	14.5%
Our Own 16% Pig & Sow Meal	Crude Protein 16.0%	15.4%
Winn Milling Co., Greensburg, Kentucky Tasty 32% Dairy Supplement	Crude Protein 32.0%	31.2%
Tasty 32% Dairy Supplement	Crude Protein 32.0%	30.7%
Woodford Feed Co., Versailles, Kentucky 3-Nitro-4 Mixture in BW Broiler, Starter & Grower	3-Nitro-4 0.005%	0.0%
Woolcott Mills, Inc., Lexington, Kentucky Sun-Ray 40% Hog Supplement	Crude Fat 3.0%	2.4%
Sun-Ray-40% Hog Supplement	Crude Protein 40.0%	38.6%